



**EGEPLAST**

"quality at plastic pipe"

# Infrastructure Product Catalogue

ALTYAPI ÜRÜN KATALOĞU  
КАТАЛОГ ПРОДУКЦИИ ДЛЯ ИНФРАСТРУКТУРЫ  
كاتالوج مجموعه البنيه التحتيه



**EGE YILDIZ**  
"plastik boruda kalite"

*Güveniniz  
Gücümüz  
Oldu...*

# Contents / İindekiler

**PVC-U BASINLI TEMİZ SU BORU VE EK PARALARI**  
PVC-U PRESSURE PIPE SYSTEMS

**PVC-U BASINLI KURŞUNSUZ TEMİZ SU BORULARI**  
PVC-U LEAD FREE PRESSURE PIPE

**KANALİZASYON BORU VE EK PARALARI**  
SEWER SYSTEMS

**EGE KORUGE BORU VE EK PARALARI**  
EGE CORRUGATED PIPE

**POLİETİLEN BORU VE EK PARALARI**  
POLYETHYLENE (PE) SYSTEMS

**DOĞAL GAZ BORU VE EK PARALARI**  
NATURAL GAS SYSTEMS

**DRENAJ BORU VE EK PARALARI**  
DRAINAGE SYSTEMS

**PE TELEKOMÜNİKASYON SİSTEMLERİ**  
PE TELECOMMUNICATION SYSTEMS



**PVC-U PRESSURE  
PIPE SYSTEMS**

**PVC-U BASINÇLI  
TEMİZ SU BORU  
VE EK PARÇALARI**



TS EN ISO 9001:2000



*Egeplast manufactures PVC-U pressure pipes for potable water systems between Ø20-Ø1000 mm sizes.*

### **PVC-U PRESSURIZED POTABLE WATER PIPES**

*Egeplast manufactures PVC-U pressure pipes between Ø20-Ø1000 mm*

*PVC-U SOCKET JOINT PIPES  
PVC-U SOLVENT CEMENT JOINT PIPES  
PVC-U PRESSURIZED FITTINGS*

*PVC-U Fittings for pressurized pipe systems are manufactured by injection and fabrication methods.*

*Egeplast, bugün PVC-U borular için üretim kapasitesini Ø1000 mm dış çapa kadar yükseltmiştir.*

### **PVC-U BASINÇLI SU BORULARI**

*Ege Yıldız PVC-U basınçlı temiz su boruları ekstrüzyon yöntemi ile üretilirken, bu borular ile birlikte kullanılan ek parçalar enjeksiyon ve konfeksiyon yöntemleri ile üretilmektedir. Ege Yıldız PVC-U basınçlı temiz su boruları TS EN ISO 1452-2 ek parçaları ise TS EN ISO 1452-3 standartına uygun olarak üretilmektedir.*



PVC-U PRESSURE PIPE SYSTEMS / PVC-U BASINÇLI BORU SİSTEMLERİ

PVC-U PIPE (Socket Joint)  
PVC-U BORU (Geçme Mufllu)

Труба ПВХ напорное водоснабжение с раструбным соединением под резиновое кольцо

انابيب ضغط يو - بس - فس - سي

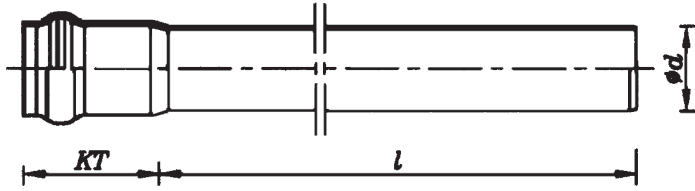

Size(d) (mm)	Bell length (KT)(mm)	Net length(l) (mm)	Product Code	Wall Thickness (mm)	Unit Weight (kg/m)	Product Code	Wall Thickness (mm)	Unit Weight (kg/m)	Product Code	Wall Thickness (mm)	Unit Weight (kg/m)	Product Code	Wall Thickness (mm)	Unit Weight (kg/m)
Çap(d) (mm)	Muf Boyu (KT)(mm)	Faydalı Boy(l) (mm)	Ürün Kodu	Et Kalınlığı (mm)	Muflu Ağırlık (kg/m)	Ürün Kodu	Et Kalınlığı (mm)	Muflu Ağırlık (kg/m)	Ürün Kodu	Et Kalınlığı (mm)	Muflu Ağırlık (kg/m)	Ürün Kodu	Et Kalınlığı (mm)	Muflu Ağırlık (kg/m)

Nominal Pressure calculated using C=2,5 safety factor/Emniyet Katsayısı C=2,5 alınarak belirlenmiş anma basınçları. PN

PN	*4 Bar / * 4 Atü	*6 Bar / * 6 Atü	*10 Bar / * 10 Atü	*16 Bar / * 16 Atü										
50	80	6000	01001050 06	1,5	0,369	01001050 10	2,4	0,552	01001050 16	3,7	0,821			
63	105	6000	01001063 06	1,9	0,578	01001063 10	3,0	0,879	01001063 16	4,7	1,317			
75	120	6000	01001075 04	1,8	0,640	01001075 06	2,2	0,792	01001075 10	3,6	1,251	01001075 16	5,6	1,872
90	130	6000	01001090 04	1,8	0,772	01001090 06	2,7	1,160	01001090 10	4,3	1,803	01001090 16	6,7	2,693

Nominal Pressure calculated using C=2,0 safety factor/Emniyet Katsayısı C=2,0 alınarak belirlenmiş anma basınçları. PN

PN	*4 Bar / * 4 Atü	*6 Bar / * 6 Atü	*10 Bar / * 10 Atü	*16 Bar / * 16 Atü										
110	130	6000	01001110 04	2,2	1,152	01001110 06	2,7	1,436	01001110 10	4,2	2,193	01001110 16	6,6	3,318
125	130	6000	01001125 04	2,5	1,469	01001125 06	3,1	1,868	01001125 10	4,8	2,826	01001125 16	7,4	4,235
140	155	6000	01001140 04	2,8	1,841	01001140 06	3,5	2,362	01001140 10	5,4	3,575	01001140 16	8,3	5,330
160	165	6000	01001160 04	3,2	2,399	01001160 06	4,0	3,080	01001160 10	6,2	4,691	01001160 16	9,5	6,965
200	185	6000	01001200 04	4,0	3,782	01001200 06	4,9	4,722	01001200 10	7,7	7,270	01001200 16	11,9	10,914
225	195	6000	01001225 04	4,5	4,776	01001225 06	5,5	5,970	01001225 10	8,6	9,158	01001225 16	13,4	13,881
250	210	6000	01001250 04	4,9	5,784	01001250 06	6,2	7,484	01001250 10	9,6	11,379	01001250 16	14,8	17,062
280	220	6000	01001280 04	5,5	7,323	01001280 06	6,9	9,316	01001280 10	10,7	14,304	01001280 16	16,6	21,427
315	230	6000	01001315 04	6,2	9,265	01001315 06	7,7	11,739	01001315 10	12,1	18,120	01001315 16	18,7	27,257
355	240	6000	01001355 04	7,0	11,824	01001355 06	8,7	14,926	01001355 10	13,6	22,926	01001355 16	21,1	34,680
400	260	6000	01001400 04	7,9	15,128	01001400 06	9,8	19,085	01001400 10	15,3	29,314	01001400 16	23,7	44,676
450	265	6000	01001450 04	8,9	20,643	01001450 06	11,0	24,153	01001450 10	17,2	37,052	01001450 16	26,7	56,771
500	280	6000	01001500 04	9,8	24,083	01001500 06	12,3	30,072	01001500 10	19,1	45,840	01001500 16	29,7	70,356
560	310	6000	01001560 04	11,0	30,485	01001560 06	13,7	37,609	01001560 10	21,4	57,716			
630	320	6000	01001630 04	12,4	38,790	01001630 06	15,4	47,676	01001630 10	24,1	73,576			
710	420	6000	01001710 04	14,0	50,369	01001710 06	17,4	60,949	01001710 10	27,2	94,406			
800	430	6000	01001800 04	15,7	63,749	01001800 06	19,6	77,987	01001800 10	30,6	121,375			
900	450	6000	01001900 04	17,7	81,038	01001900 06	22,0	98,646						
1000	470	6000	010011100 04	19,7	100,460	010011100 06	24,5	122,494						

Note:\* 4 Bar PVC-U Pipes are not in the scope of TS EN ISO 1452-2, however can be manufactured upon request.

Not:\* 4 Atü PVC borular TS EN ISO 1452-2 kapsamında olmayıp, özel olarak üretilmektedir.

PVC-U PRESSURE PIPE SYSTEMS / PVC-U BASINÇLI BORU SİSTEMLERİ

PVC-U PIPE (Solvent Cement Joint)  
PVC-U BORU (Yapıştırma Muflu)  
Труба ПВХ напорное водоснабжение с  
раструбом под клеевое соединение  
عكاس تنصیق

Infrastructure Group / Altyapı Grubu

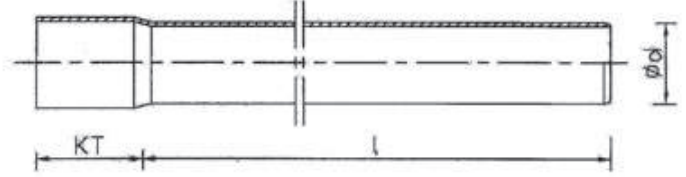

Size(d) (mm)	Bell length (KT)(mm)	Net length(l) (mm)	Product Code	Wall Thickness (mm)	Unit Weight (kg/m)	Product Code	Wall Thickness (mm)	Unit Weight (kg/m)	Product Code	Wall Thickness (mm)	Unit Weight (kg/m)	Product Code	Wall Thickness (mm)	Unit Weight (kg/m)
Çap(d) (mm)	Muf Boyu (KT)(mm)	Faydalı Boy(l) (mm)	Ürün Kodu	Et Kalınlığı (mm)	Muflu Ağırlık (kg/m)	Ürün Kodu	Et Kalınlığı (mm)	Muflu Ağırlık (kg/m)	Ürün Kodu	Et Kalınlığı (mm)	Muflu Ağırlık (kg/m)	Ürün Kodu	Et Kalınlığı (mm)	Muflu Ağırlık (kg/m)

Nominal Pressure calculated using C=2,5 safety factor/Emniyet Katsayısı C=2,5 alınarak belirlenmiş anma basınçları. PN

PN	*4 Bar / * 4 Atü	*6 Bar / * 6 Atü	*10 Bar / * 10 Atü	*16 Bar / * 16 Atü
20	30	6000		02001020 16
25	35	6000		02001025 16
32	40	6000		02001032 16
40	45	6000	02001040 06	02001040 16
50	50	6000	02001050 06	02001050 16
63	70	6000	02001063 06	01001063 16
75	80	6000	02001075 06	01001075 16
90	90	6000	02001090 04	01001090 16

Nominal Pressure calculated using C=2,0 safety factor/Emniyet Katsayısı C=2,0 alınarak belirlenmiş anma basınçları. PN

PN	*4 Bar / * 4 Atü	*6 Bar / * 6 Atü	*10 Bar / * 10 Atü	*16 Bar / * 16 Atü
110	100	6000	02001110AT 06	02001110AT 16
125	120	6000	02001125AT 06	02001125AT 16
140	130	6000	02001140AT 06	02001140AT 16
160	140	6000	02001160AT 06	02001160AT 16
200	160	6000	02001200AT 06	02001200AT 16
225	180	6000	02001225AT 06	02001225AT 16
250	200	6000	02001250AT 06	02001250AT 16
280	210	6000	02001280AT 06	02001280AT 16
315	230	6000	02001315AT 06	02001315AT 16
355	250	6000	02001355AT 06	02001355AT 16
400	270	6000	02001355AT 06	02001355AT 16

Note:\* 4 Bar PVC-U Pipes are not in the scope of TS EN ISO 1452-2, however can be manufactured upon request.  
Not:\* 4 Atü PVC borular TS EN ISO 1452-2 kapsamında olmayıp, özel olarak üretilmektedir.



PVC-U PRESSURE PIPE SYSTEMS / PVC-U BASINÇLI BORU SİSTEMLERİ

PVC-U PIPE (Socket Joint)

PVC-U BORU (Geçme Muflu)

Труба ПВХ напорное водоснабжение с раструбным соединением под резиновое кольцо

انابيب ضغط يو - بي - في - سي

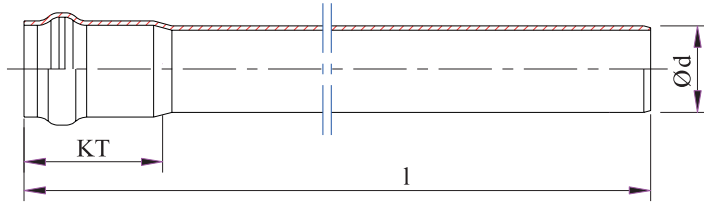

Total L (with socket):6 mt

Toplam boy ( muf dahil):6 mt



Size(d) (mm)	Bell length (KT)(mm)	Net length(l) (mm)	Product Code	Wall Thickness (mm)	Unit Weight (kg/m)	Product Code	Wall Thickness (mm)	Unit Weight (kg/m)	Product Code	Wall Thickness (mm)	Unit Weight (kg/m)	Product Code	Wall Thickness (mm)	Unit Weight (kg/m)
Çap(d) (mm)	Muf Boyu (KT)(mm)	Faydalı Boy(l) (mm)	Ürün Kodu	Et Kalınlığı (mm)	Muflu Ağırlık (kg/m)	Ürün Kodu	Et Kalınlığı (mm)	Muflu Ağırlık (kg/m)	Ürün Kodu	Et Kalınlığı (mm)	Muflu Ağırlık (kg/m)	Ürün Kodu	Et Kalınlığı (mm)	Muflu Ağırlık (kg/m)
<b>Nominal Pressure calculated using C=2,5 safety factor/Emniyet Katsayısı C=2,5 alınarak belirlenmiş anma basınçları. PN</b>														
PN	*4 Bar / * 4 Atü					*6 Bar / * 6 Atü			*10 Bar / * 10 Atü			*16 Bar / * 16 Atü		
50	80	6000				01001050KS 06	1,5	0,369	01001050KS 10	2,4	0,545	01001050KS 16	3,7	0,821
63	100	6000				01001063KS 06	1,9	0,578	01001063KS 10	3,0	0,865	01001063KS 16	4,7	1,317
75	125	6000	01001075KS 04	1,5	0,262	01001075KS 06	2,2	0,792	01001075KS 10	3,6	1,225	01001075KS 16	5,6	1,872
90	125	6000	01001090KS 04	1,8	0,756	01001090KS 06	2,7	1,160	01001090KS 10	4,3	1,765	01001090KS 16	6,7	2,693
110	125	6000	01001110KS 04	2,2	1,128	01001110KS 06	2,7	1,436	01001110KS 10	5,3	2,636	01001110KS 16	6,6	3,318
125	130	6000	01001125KS 04	2,5	1,437	01001125KS 06	3,1	1,868	01001125KS 10	6,0	3,390	01001125KS 16	7,4	4,235
140	150	6000	01001400KS 04	2,8	1,795	01001400KS 06	3,5	2,362	01001400KS 10	6,7	4,236	01001400KS 16	8,3	5,330
160	160	6000	01001160KS 04	3,2	2,337	01001160KS 06	4,0	3,080	01001160KS 10	7,7	5,554	01001160KS 16	9,5	6,965
200	175	6000	01001200KS 04	3,9	3,675	01001200KS 06	4,9	4,722	01001200KS 10	9,6	8,644	01001200KS 16	11,9	10,914
225	185	6000	01001225KS 04	4,4	4,634	01001225KS 06	5,5	5,970	01001225KS 10	10,8	11,014	01001225KS 16	13,4	13,881
250	200	6000	01001250KS 04	4,9	5,598	01001250KS 06	6,2	7,484	01001250KS 10	11,9	13,472	01001250KS 16	14,8	17,062
280	210	6000	01001280KS 04	5,5	7,077	01001280KS 06	6,9	9,316	01001280KS 10	13,4	16,915	01001280KS 16	16,6	21,427
315	220	6000	01001315KS 04	6,2	8,939	01001315KS 06	7,7	11,739	01001315KS 10	15,0	21,365	01001315KS 16	18,7	27,257
355	230	6000	01001355KS 04	7,0	11,390	01001355KS 06	8,7	14,926	01001355KS 10	16,9	27,046	01001355KS 16	21,1	34,680
400	250	6000	01001400KS 04	7,9	14,256	01001400KS 06	9,8	19,085	01001400KS 10	19,1	34,339	01001400KS 16	23,7	44,676
450	270	6000	01001450KS 04	8,9	19,791				01001450KS 10	21,5	44,094			
500	280	6000	01001500KS 04	9,8	23,016	01001500KS 06	12,3	30,072	01001500KS 10	23,9	54,437			
630	320	6000	01001630KS 04	12,3	36,838	01001630KS 06	13,7	37,609	01001630KS 10	30,0	86,047			
710	400	6000	01001700KS 04	13,9	47,245	01001700KS 06	15,4	47,676						
800	410	6000	01001800KS 04	15,7	59,703	01001800KS 06	17,4	60,949						
900	430	6000	01001900KS 04	17,6	75,660	01001900KS 06	19,6	77,987						
1000	470	6000	01001000KS 04	19,6	93,505	01001000KS 06	22,0	98,646						

\* According to standart DIN 8061 & DIN 8062

\*\* (PN=Nominal Pressure, OD=Outside diameter, S=Minimum Wall Thickness, EA=Each, KT=Lenght of Socket)

\*\*\* (\*) Marked pipes order is to be confirmed by Egeplast.

PVC-U PRESSURE PIPE SYSTEMS / PVC-U BASINÇLI BORU SİSTEMLERİ

BEND (Socket Joint)  
DEVE BOYNU (Geçme Muflu)  
ПВХ отвод с раструбным  
соединением под резиновое кольцо  
عكاس

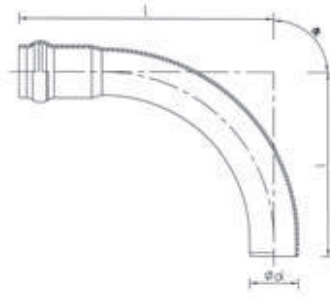

BEND Socked Joint PN 10 / DEVE BOYNU (Geçme Muflu) PN 10

Angle Açı	11°		22°		30°		45°		60°		90°	
	Code/Kod	l (mm)	Code/Kod	l (mm)	Code/Kod	l (mm)	Code/Kod	l (mm)	Code/Kod	l (mm)	Code/Kod	l (mm)
25	01006025001110	xxx	01006025002210	xxx	01006025003010	xxx	01006025004510	xxx	01006025001110	xxx	01006025009010	xxx
32	01006032001110	xxx	01006032002210	xxx	01006032003010	xxx	01006032004510	xxx	01006032001110	xxx	01006032009010	xxx
40	01006040001110	xxx	01006040002210	xxx	01006040003010	xxx	01006040004510	xxx	01006040001110	xxx	01006040009010	xxx
50	01006050001110	xxx	01006050002210	xxx	01006050003010	xxx	01006050004510	xxx	01006050001110	xxx	01006050009010	xxx
63	01006063001110	151	01006063002210	173	01006063003010	186	01006063004510	222	01006063001110	258	01006063009010	351
75	01006075001110	175	01006075002210	201	01006075003010	220	01006075004510	259	01006075001110	302	01006075009010	413
90	01006090001110	196	01006090002210	227	01006090003010	250	01006090004510	296	01006090001110	348	01006090009010	481
110	01006110001110	214	01006110002210	252	01006110003010	280	01006110004510	336	01006110001110	399	01006110009010	562
125	01006125001110	222	01006125002210	275	01006125003010	307	01006125004510	371	01006125001110	443	01006125009010	628
140	01006140001110	253	01006140002210	301	01006140003010	337	01006140004510	409	01006140001110	489	01006140009010	696
160	01006160001110	290	01006160002210	345	01006160003010	386	01006160004510	468	01006160001110	559	01006160009010	796
200	01006200001110	338	01006200002210	407	01006200003010	459	01006200004510	561	01006200001110	675	01006200009010	971
225	01006225001110	366	01006225002210	443	01006225003010	501	01006225004510	616	01006225001110	745	01006225009010	1078
250	01006250001110	399	01006250002210	485	01006250003010	549	01006250004510	677	01006250001110	820	01006250009010	1190
280	01006280001110	426	01006280002210	522	01006280003010	595	01006280004510	738	01006280001110	898	01006280009010	1312
315	01006315001110	470	01006315002210	578	01006315003010	659	01006315004510	821	01006315001110	1001	01006315009010	1467
355	01006355001110	505	01006355002210	627	01006355003010	718	01006355004510	899	01006355001110	1102	01006355009010	1628
400	01006400001110	558	01006400002210	695	01006400003010	798	01006400004510	1003	01006400001110	1231	01006400009010	1823

BEND Socked Joint PN 16 / DEVE BOYNU (Geçme Muflu) PN 16

Angle Açı	11°		22°		30°		45°		60°		90°	
	Code/Kod	l (mm)	Code/Kod	l (mm)	Code/Kod	l (mm)	Code/Kod	l (mm)	Code/Kod	l (mm)	Code/Kod	l (mm)
20	01006020001116	xxx	01006032002216	xxx	01006032003016	xxx	01006032004516	xxx	01006032001116	xxx	01006032009016	xxx
25	01006025001116	xxx	01006025002216	xxx	01006025003016	xxx	01006025004516	xxx	01006025001116	xxx	01006025009016	xxx
32	01006032001116	xxx	01006032002216	xxx	01006032003016	xxx	01006032004516	xxx	01006032001116	xxx	01006032009016	xxx
40	01006040001116	xxx	01006040002216	xxx	01006040003016	xxx	01006040004516	xxx	01006040001116	xxx	01006040009016	xxx
50	01006050001116	xxx	01006050002216	xxx	01006050003016	xxx	01006050004516	xxx	01006050001116	xxx	01006050009016	xxx
63	01006063001116	151	01006063002216	173	01006063003016	186	01006063004516	222	01006063001116	258	01006063009016	351
75	01006075001116	175	01006075002216	201	01006075003016	220	01006075004516	259	01006075001116	302	01006075009016	413
90	01006090001116	196	01006090002216	227	01006090003016	250	01006090004516	296	01006090001116	348	01006090009016	481
110	01006110001116	214	01006110002216	252	01006110003016	280	01006110004516	336	01006110001116	399	01006110009016	562
125	01006125001116	222	01006125002216	275	01006125003016	307	01006125004516	371	01006125001116	443	01006125009016	628
140	01006140001116	253	01006140002216	301	01006140003016	337	01006140004516	409	01006140001116	489	01006140009016	696
160	01006160001116	290	01006160002216	345	01006160003016	386	01006160004516	468	01006160001116	559	01006160009016	796
200	01006200001116	338	01006200002216	407	01006200003016	459	01006200004516	561	01006200001116	675	01006200009016	971
225	01006225001116	366	01006225002216	443	01006225003016	501	01006225004516	616	01006225001116	745	01006225009016	1078
250	01006250001116	399	01006250002216	485	01006250003016	549	01006250004516	677	01006250001116	820	01006250009016	1190
280	01006280001116	426	01006280002216	522	01006280003016	595	01006280004516	738	01006280001116	898	01006280009016	1312
315	01006315001116	470	01006315002216	578	01006315003016	659	01006315004516	821	01006315001116	1001	01006315009016	1467
355	01006355001116	505	01006355002216	627	01006355003016	718	01006355004516	899	01006355001116	1102	01006355009016	1628
400	01006400001116	558	01006400002216	695	01006400003016	798	01006400004516	1003	01006400001116	1231	01006400009016	1823
500	01006500001116	670	01006500002216	840	01006500003016	970	01006500004516	1225	01006500001116	1510	01006500009016	2250

Note: Diameters, over 500 mm are manufactured upon request.

Not: Dış çap 500 mm üzeri deve boynu özel olarak üretilmektedir.

**PVC-U  
LEAD FREE  
PRESSURE PIPE**

**PVC-U KURŞUNSUZ  
BASINÇLI  
TEMİZ SU BORULARI**

*Environmentally friendly  
with human health  
Lead free pressure pipe*

*Çevreye Duyarlı,  
İnsan sağlığı ile dost  
Kurşunsuz Boru*



TS EN ISO 9001:2000

## Calcium-Zinc based PVC-U Pipes

In 1960's, pipes made by PVC material started to be used as they were healthy, light, resistant to corrosion and easy to install instead of carcinogenic asbestos pipes.

However, stabilizers which consist of some chemicals are used to prevent from high temperature during the production process of PVC pipes. The heavy metal ingredients always exist as a threat to health, although the effect of the stabilizers to the drinking water remains in the limits defined in Food Codex.

European Community has applied protective actions in this manner like their pioneer roles in other fields.

Calcium-Zinc based PVC pipes have been considered as the best alternative for drinking water applications since they do not consist of heavy metals that threaten human health.

"The Toxics Use Reduction Institute" defined Calcium-Zinc as a primary stabilizer for PVC in the year 2006. Moreover, "Vinyl Plus Task Force Organisation" announced that the use of Calcium-Zinc stabilizer reached to 60% of total use in European Countries. Meanwhile, Calcium and Zinc elements are non-toxic, natural and necessary for human health.

In addition to the superiority of Calcium-Zinc based PVC pipes for health, there are technical superiorities as well:

**Long Time UV Protection:** As Calcium-Zinc stabilizers protect PVC-U pipes from UV Radiation, they have more advantage from other stabilizers. Depending on that; color and mechanical properties of pipes are protected for a long time.

**High Mechanical Strength:** Calcium-Zinc based pipes have higher mechanical strength (pressure and impact)

Its goodness for health has been proved by "HIFZISSI-HHA INSTITUTE" which belongs to the Ministry of Health with 01802 reference protocol report.

## Kalsiyum-Çinko stabilizatörlü PVC-U borular

PVC malzemeden mamul borular, 1960'lı yıllarda sağlıklı olmaları, sağlamlıkları, hafiflikleri, korozyona dayanımları ve montaj kolaylıkları gibi nedenlerle kanserojen olan asbestli borular yerine kullanılmaya başlanmıştır.

Ancak PVC boruların üretimi sırasında yüksek sıcaklıktan korunmaları için, içeriğinde bir takım kimyasallar bulunan stabilizatörler kullanılmaktadır. Bu stabilizatörlerin içme sularına etkisi, Gıda kodeksinde belirtilen sınırlar içerisinde kalmasına rağmen, bünyesinde bulundurduğu ağır metaller sağlık açısından her zaman tehdit oluşturmıştır.

Avrupa topluluğu ülkeleri her alanda olduğu gibi bu alanda da öncü rol üstlenip koruyucu tedbirler uygulamaya başlamışlardır.

2006 yılında "The Toxics Use Reduction Institute" PVC' de kullanılacak birincil stabilizatör olarak Kalsiyum-Çinko stabilizatörlerini belirlemiştir.

Kalsiyum-Çinko stabilizatörleri bünyesinde insan sağlığını tehdit eden ağır metal bulundurmadığından temiz su boru üretiminde kullanılacak en iyi alternatif olarak görülmektedir.

Ayrıca Avrupa'nın "Vinyl Plus Task Force" organizasyonu Kalsiyum-Çinko stabilizatörü kullanımının %60'a ulaştığını belirlemiştir.

Bütün bunların yanında kalsiyum ve çinko, doğal olarak zehirsiz ve insan sağlığı için gerekli elementler olarak belirtilmektedir.

Kalsiyum Çinko Stabilizatörlü PVC-U boruların, sağlık açısından bu önemli üstünlüğünün yanında, teknik olarak diğer üstünlükleri ise;

**Uzun süreli UV koruması;** Kalsiyum-Çinko stabilizatörleri, PVC-U boruları uzun süre UV radyasyonundan koruması nedeniyle, diğer stabilizatörlerden daha avantajlıdır. Böylece uzun süre borunun renginin ve mekanik özelliklerinin korunması mümkündür.

**Yüksek Mekanik Dayanım;** Kalsiyum-Çinko stabilizatörleri ile üretilen borular, daha yüksek mekanik dayanıma (basınç ve darbe) sahiptirler.

PVC-U LEAD FREE PRESSURE PIPE / PVC-U KURŞUNSUZ BASINÇLI TEMİZ SU BORULARI

PVC-U LEAD FREE PRESSURE PIPE (Socket Joint)  
PVC-U KURŞUNSUZ BASINÇLI BORU (Geçme Mufu)  
ПВХ Трубы Без Свинца(с раструбным соединением под резиновое кольцо)  
انابيب يو بي في سي خاليه من الرصاص مع جوان

Infrastructure Group / Altyapı Grubu

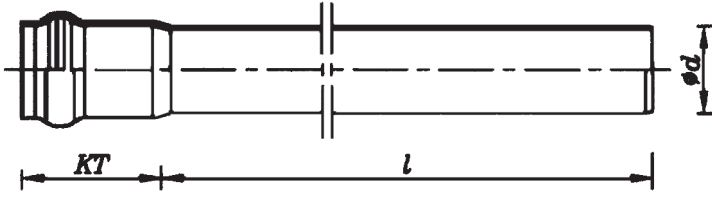

Size(d) (mm)	Bell length (KT)(mm)	Net length(l) (mm)	Product Code	Wall Thickness (mm)	Unit Weight (kg/m)	Product Code	Wall Thickness (mm)	Unit Weight (kg/m)	Product Code	Wall Thickness (mm)	Unit Weight (kg/m)	Product Code	Wall Thickness (mm)	Unit Weight (kg/m)
Çap(d) (mm)	Muf Boyu (KT)(mm)	Faydalı Boy(l) (mm)	Ürün Kodu	Et Kalınlığı (mm)	Muf lu Ağırlık (kg/m)	Ürün Kodu	Et Kalınlığı (mm)	Muf lu Ağırlık (kg/m)	Ürün Kodu	Et Kalınlığı (mm)	Muf lu Ağırlık (kg/m)	Ürün Kodu	Et Kalınlığı (mm)	Muf lu Ağırlık (kg/m)
<b>Nominal Pressure calculated using C=2,5 safety factor/Emniyet Katsayısı C=2,5 alınarak belirlenmiş anma basınçları. PN</b>														
PN			<b>*4 Bar / * 4 Atü</b>			<b>*6 Bar / * 6 Atü</b>			<b>*10 Bar / * 10 Atü</b>			<b>*16 Bar / * 16 Atü</b>		
50	80	6000				03001050 06	1,5	0,369	03001050 10	2,4	0,552	03003050 16	3,7	0,821
63	105	6000				03001063 06	1,9	0,578	03001063 10	3,0	0,879	03003063 16	4,7	1,317
75	120	6000	03001075 04	1,8	0,640	03001075 06	2,2	0,792	03001075 10	3,6	1,251	03003075 16	5,6	1,872
90	130	6000	03001090 04	1,8	0,772	03001090 06	2,7	1,160	03001090 10	4,3	1,803	03003090 16	6,7	2,693
<b>Nominal Pressure calculated using C=2,0 safety factor/Emniyet Katsayısı C=2,0 alınarak belirlenmiş anma basınçları. PN</b>														
PN			<b>*4 Bar / * 4 Atü</b>			<b>*6 Bar / * 6 Atü</b>			<b>*10 Bar / * 10 Atü</b>			<b>*16 Bar / * 16 Atü</b>		
110	130	6000	03003110 04	2,2	1,152	03003110AT 06	2,7	1,436	03003110AT 10	4,2	2,193	03003110AT 16	6,6	3,318
125	130	6000	03003125 04	2,5	1,469	03003125AT 06	3,1	1,868	03003125AT 10	4,8	2,826	03003125AT 16	7,4	4,235
140	155	6000	03003140 04	2,8	1,841	03003140AT 06	3,5	2,362	03003140AT 10	5,4	3,575	03003140AT 16	8,3	5,330
160	165	6000	03003160 04	3,2	2,399	03003160AT 06	4,0	3,080	03003160AT 10	6,2	4,691	03003160AT 16	9,5	6,965
200	185	6000	03003200 04	4,0	3,782	03003200AT 06	4,9	4,722	03003200AT 10	7,7	7,270	03003200AT 16	11,9	10,914
225	195	6000	03003225 04	4,5	4,776	03003225AT 06	5,5	5,970	03003225AT 10	8,6	9,158	03003225AT 16	13,4	13,881
250	210	6000	03003250 04	4,9	5,784	03003250AT 06	6,2	7,484	03003250AT 10	9,6	11,379	03003250AT 16	14,8	17,062
280	220	6000	03003280 04	5,5	7,323	03003280AT 06	6,9	9,316	03003280AT 10	10,7	14,304	03003280AT 16	16,6	21,427
315	230	6000	03003315 04	6,2	9,265	03003315AT 06	7,7	11,739	03003315AT 10	12,1	18,120	03003315AT 16	18,7	27,257
355	240	6000	03003355 04	7,0	11,824	03003355AT 06	8,7	14,926	03003355AT 10	13,6	22,926			
400	260	6000	03003400 04	7,9	15,128	03003400AT 06	9,8	19,085	03003400AT 10	15,3	29,314			
450	265	6000	03003450 04	8,9	20,643	03003450AT 06	11,0	24,153	03003450AT 10	17,2	37,052			
500	280	6000	03003500 04	9,8	24,083	03003500AT 06	12,3	30,072	03003500AT 10	19,1	45,840			
630	320	6000	03003630 04	12,4	38,790	03003630AT 06	15,4	47,676	03003630AT 10	24,1	73,576			

Note:\* 4 Bar PVC-U Pipes are not in the scope of TS EN ISO 1452-2, however can be manufactured upon request.  
Not:\* 4 Atü PVC borular TS EN ISO 1452-2 kapsamında olmayıp, özel olarak üretilmektedir.



PVC-U LEAD FREE PRESSURE PIPE (Solvent Cement Joint)  
PVC-U KURŞUNSUZ BASINÇLI BORU (Yapıştırma Mufu)

ПВХ Трубы Без Свинца (с раструбом под клеевое соединение)

انابيب يو بي في سي خاليه من الرصاص بالتصليق

Infrastructure Group / Altyapı Grubu

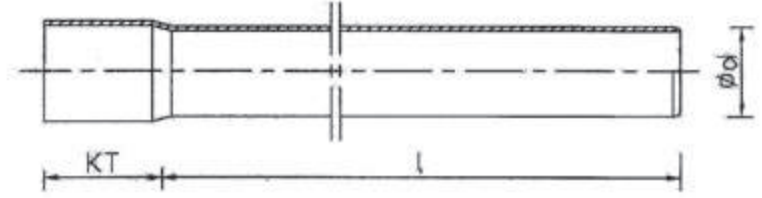
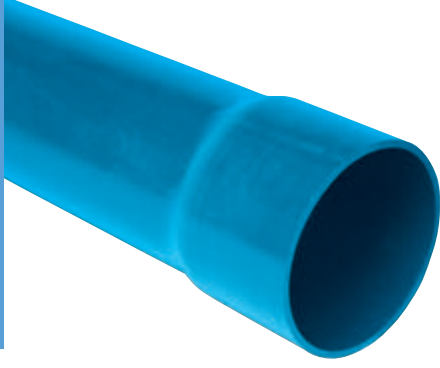

Size(d) (mm)	Bell length (KT)(mm)	Net length(l) (mm)	Product Code	Wall Thickness (mm)	Unit Weight (kg/m)	Product Code	Wall Thickness (mm)	Unit Weight (kg/m)	Product Code	Wall Thickness (mm)	Unit Weight (kg/m)	Product Code	Wall Thickness (mm)	Unit Weight (kg/m)
Çap(d) (mm)	Muf Boyu (KT)(mm)	Faydalı Boy(l) (mm)	Ürün Kodu	Et Kalınlığı (mm)	Mufu Ağırlık (kg/m)	Ürün Kodu	Et Kalınlığı (mm)	Mufu Ağırlık (kg/m)	Ürün Kodu	Et Kalınlığı (mm)	Mufu Ağırlık (kg/m)	Ürün Kodu	Et Kalınlığı (mm)	Mufu Ağırlık (kg/m)
<b>Nominal Pressure calculated using C=2,5 safety factor/Emniyet Katsayısı C=2,5 alınarak belirlenmiş anma basınçları. PN</b>														
PN			<b>*4 Bar / * 4 Atü</b>			<b>*6 Bar / * 6 Atü</b>			<b>*10 Bar / * 10 Atü</b>			<b>*16 Bar / * 16 Atü</b>		
20	30	6000										02001020 16	1,5	0,137
25	35	6000										02001025 16	1,9	1,215
32	40	6000							03004032 10	1,6	0,244	02001032 16	2,4	0,345
40	45	6000				03004040 06	1,5	0,292	03004040 10	1,9	0,358	02001040 16	3,0	0,535
50	50	6000				03004050 06	1,5	0,369	03004050 10	2,4	0,552	02001050 16	3,7	0,821
63	70	6000				03004063 06	1,9	0,574	03004063 10	3,0	0,864	01001063 16	4,7	1,303
75	80	6000	03004075 04	1,8	0,634	03004075 06	2,2	0,784	03004075 10	3,6	1,226	01001075 16	5,6	1,834
90	90	6000	03004090 04	1,8	0,766	03004090 06	2,7	1,151	03004090 10	4,3	1,776	01001090 16	6,7	2,639
<b>Nominal Pressure calculated using C=2,0 safety factor/Emniyet Katsayısı C=2,0 alınarak belirlenmiş anma basınçları. PN</b>														
PN			<b>*4 Bar / * 4 Atü</b>			<b>*6 Bar / * 6 Atü</b>			<b>*10 Bar / * 10 Atü</b>			<b>*16 Bar / * 16 Atü</b>		
110	100	6000	03004110 04	2,2	1,137	02001110AT 06	2,7	1,427	03004110AT 10	4,2	2,175	02001110AT 16	6,6	3,291
125	120	6000	03004125 04	2,5	1,462	02001125AT 06	3,1	1,856	03004125AT 10	4,8	2,808	02001125AT 16	7,4	4,208
140	130	6000	03004140 04	2,8	1,829	02001140AT 06	3,5	2,343	03004140AT 10	5,4	3,546	02001140AT 16	8,3	5,287
160	140	6000	03004160 04	3,2	2,384	02001160AT 06	4,0	3,055	03004160AT 10	6,2	4,653	02001160AT 16	9,5	6,909
200	160	6000	03004200 04	4,0	3,758	02001200AT 06	4,9	4,676	03004200AT 10	7,7	7,200	02001200AT 16	11,9	10,809
225	180	6000	03004225 04	4,5	4,753	02001225AT 06	5,5	5,913	03004225AT 10	8,6	9,070	02001225AT 16	13,4	13,747
250	200	6000	03004250 04	4,9	5,756	02001250AT 06	6,2	7,414	03004250AT 10	9,6	11,270	02001250AT 16	14,8	16,899
280	210	6000	03004280 04	5,5	7,288	02001280AT 06	6,9	9,242	03004280AT 10	10,7	14,190	02001280AT 16	16,6	21,256
315	230	6000	03004315 04	6,2	9,235	02001315AT 06	7,7	11,627	03004315AT 10	12,1	17,641	02001315AT 16	18,7	26,997
355	250	6000	03004355 04	7,0	11,805	02001355AT 06	8,7	14,831	03004355AT 10	13,6	22,477	02001355AT 16	21,1	34,459
400	270	6000	03004355 04	7,9	15,104	02001355AT 06	9,8	18,994	03004355AT 10	15,3	28,500	02001355AT 16	23,7	43,867

Note:\* 4 Bar PVC-U Pipes are not in the scope of TS EN ISO 1452-2, however can be manufactured upon request.  
Not:\* 4 Atü PVC borular TS EN ISO 1452-2 kapsamında olmayıp, özel olarak üretilmektedir.

PVC-U PRESSURE PIPE SYSTEMS / PVC-U BASINÇLI BORU SİSTEMLERİ

SLEEVE ( SOLVENT CEMENT )  
MANŞON (Yapıştırma)  
ПВХ муфта (клеевое соединение)  
وصلة

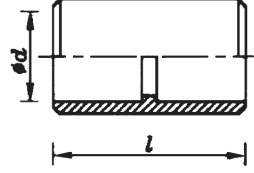

ITEM CODE	Ød(mm)	l(mm)
Kod No	Ød(mm)	l(mm)
01015020	20	50
01015025	25	54
01015032	32	80
01015040	40	100
01015050	50	130
02015063	63	170
02015075	75	190
02015090	90	200
02015110	110	230
02015125	125	250
02015140	140	270
02015160	160	295
02015200	200	365
02015225	225	400
02015250	250	450
02015280	280	470
02015315	315	500
02015355	355	540
02015400	400	580
02015500	500	590

Note: Pressure ratings are 10 and 16 bar  
Not: Basınç sınıfı PN 10 ve 16' dir

COLLAR SLEEVE  
KAYAR MANŞON  
ПВХ муфта (клеевое соединение)  
وصلة مزدوجة

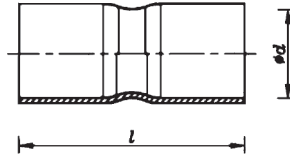

ITEM CODE	Ød(mm)	l(mm)
Kod No	Ød(mm)	l(mm)
01017050	50	xxx
01017063	63	225
01017075	75	255
01017090	90	275
01017110	110	290

PVC COLLAR SLEEVE (Socket Joint) PN 10  
PVC KAYAR MANŞON (Geçme Muflu) PN 10  
ПВХ муфта ремонтная  
وصلة بجوان

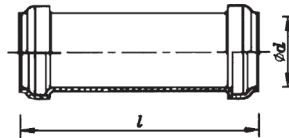

ITEM CODE	Ød(mm)	l(mm)
Kod No	Ød(mm)	l(mm)
01017125	125	290
01017140	140	300
01017160	160	300
01017200	200	370
01017225	225	390
01017250	250	480
01017280	280	480
01017315	315	580
01017355	355	570
01017400	400	660
01017500	500	790
01017630	630	830

PVC-U PRESSURE PIPE SYSTEMS / PVC-U BASINÇLI BORU SİSTEMLERİ

PVC COLLAR SLEEVE (Socket Joint) PN 16  
PVC KAYAR MANŞON (Geçme Muflu) PN 16

ПВХ муфта ремонтная  
وصلة بجوان

ITEM CODE	Ød(mm)	l(mm)
Kod No	Ød(mm)	l(mm)
01017050	50	xxx
01017063	63	225
01017075	75	255
01017090	90	275
01017110	110	290
01017125	125	290
01017140	140	300
01017160	160	300
01017200	200	370
01017225	225	390
01017250	250	480
01017280	280	480
01017315	315	580
01017355	355	570
01017400	400	660
01017500	500	790

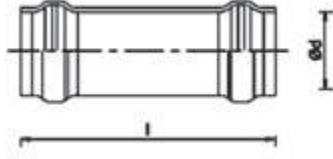

THREADED SLEEVE  
DİŞLİ MANŞON  
ПВХ резьбовая муфта  
وصلة مسنن

ITEM CODE	R"	l(mm)
Kod No	R"	l(mm)
10016020	1/2"	45
10016025	3/3"	50

Note: Pressure rating is 16 bar  
Not: Basınç sınıfı PN 16' dir.

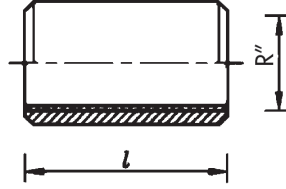

THREADED SLEEVE  
DİŞLİ MANŞON  
ПВХ резьбовая муфта  
وصلة مسنن انشى

ITEM CODE	R"	l(mm)
Kod No	R"	l(mm)
10016032	1"	42

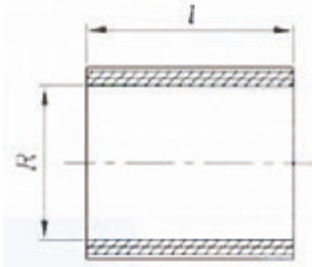

ELBOW ( Solvent Cement Joint) 90°  
DİRSEK ( Yarıştırma) 90°  
ПВХ угольник 90° (клеевое соединение)  
90° كوع

ITEM CODE	R"	l(mm)
Kod No	R"	l(mm)
01008020	20	28
01008025	25	33
01008032	32	40
01008040	40	51
01008050	50	59
01008063	63	69
01008075*	75	69
01008090*	90	79
01008110*	110	89
01008125*	125	99
01008140*	140	109
01008160*	160	119
01008200*	200	149

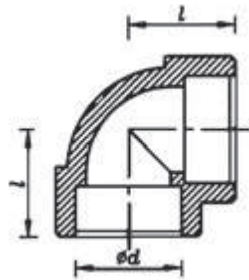

Note: Pressure rating is 16 bar for 160 mm. O.d. and smaller diameters.  
Not: Basınç sınıfı çap 160mm'ye kadar PN 16' dir

Note: \* Marked items can be procured upon request.  
Not: Üretim setimizde olmayan ve "\*" ile belirtilen ürünler talep edildiğinde temin edilebilir.



PVC-U PRESSURE PIPE SYSTEMS / PVC-U BASINÇLI BORU SİSTEMLERİ

ELBOW ( Solvent Cement Joint) 45°  
DİRSEK ( Yapıştırma) 45°  
ПВХ угольник 45° (клеевое соединение)  
45° كوع

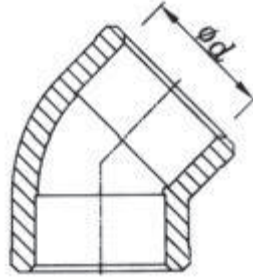

ITEM CODE R"

Kod No R"

010080200045	20
010080250045	25
010080320045*	32
010080400045*	40
010080500045*	50
010080630045*	63
010080750045*	75
010080900045*	90
010081100045*	110
010081250045*	125
010081400045*	140
010081600045*	160
010082000045*	200

THREADED ELBOW 90°  
DİŞLİ DİRSEK 90°  
ПВХ угольник с вн.р. 90°  
90° كوع مسنن

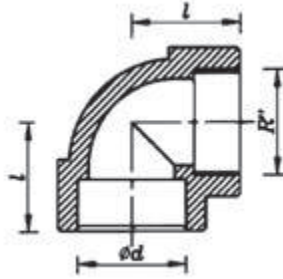

ITEM CODE d(mm) R" l(mm)

Kod No d(mm) R" l(mm)

01007020	20	1/2"	28
01007025	25	3/4"	33
01007032	32	1"	40
01007040	40	1 1/4"	51
01007050	50	1 1/2"	59

Note: Pressure rating is 16 bar.

Not: Basınç sınıfı PN 16' dir.

Note: \* Marked items can be procured upon request.

Not: Üretim setimizde olmayan ve " \* " ile belirtilen ürünler talep edildiğinde temin edilebilir.

PVC-U PRESSURE PIPE SYSTEMS / PVC-U BASINÇLI BORU SİSTEMLERİ

TEE (Solvent Cement Joint)  
TE (Yapıştırma)  
ПВХ тройник (клеевое соединение)  
تي

ITEM CODE	d1(mm)	d2(mm)	l1(mm)	l2(mm)
Kod No	d1(mm)	d2(mm)	l1(mm)	l2(mm)
01025020	20	20	54	29
01025025	25	25	64	33
01025032	32	32	78	40
01025040	40	40	101	50
01025050	50	50	119	60
01025063	63	63	119	60
010250750050	75	50	168	70
010250750063	75	63	168	76
01025075	75	75	168	84
010250900063	90	63	195	86
010250900075	90	75	195	92
01025090	90	90	195	75
010251100075	110	75	232	100
010251100090	110	90	232	107
010251100110	110	110	232	116
01025125*	125	125		
01025140*	140	140		
01025160*	160	160		
01025200*	200	200		

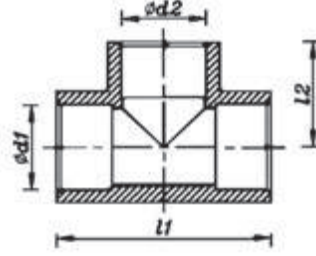

Note: Pressure rating is 16 bar for 160 mm O.D. and smaller diameters.  
Not: Basınç sınıfı çap 160 mm'ye kadar PN 16' dir.

Note: \* Marked items can be procured upon request.  
Not: Üretim setimizde olmayan ve "\*" ile belirtilen ürünler talep edildiğinde temin edilebilir.

THREADED TEE  
DİŞLİ TE  
ПВХ тройник резьбовой  
تي مسننة انش

ITEM CODE	d1(mm)	R"	l1(mm)	l2(mm)
Kod No	d1(mm)	R"	l1(mm)	l2(mm)
01023020	20	1/2"	54	29
01023025	25	3/4"	64	33
01023032	32	1"	78	40
01023040	40	1 1/4"	101	50
01023050	50	1 1/2"	125	62
01023063	63	2"	119	60
01023075	75	2 1/2"	75	

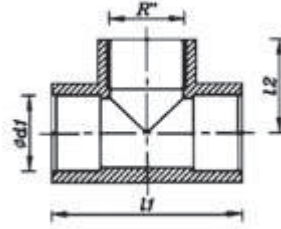

TEE (Socket Joint-Injection)  
TEE (Geçme Muflu-Enjeksiyon)  
ПВХ тройник (с раструбным соединением под резиновое кольцо - инъекционный)  
مشترك بطريقه الحقن

ITEM CODE	Ød(mm)	PN(bar)	Ød1(mm)	l(mm)	l1(mm)
Kod No	Ød(mm)	Basınç Sınıfı(bar)	Ød1(mm)	l(mm)	l1(mm)
010251600160E	20	1/2"	20	54	29
010251600110E	25	3/4"	25	64	33
010252000160E	32	1"	32	78	40
010252000110E	40	1 1/4"	40	101	50





PVC-U PRESSURE PIPE SYSTEMS / PVC-U BASINÇLI BORU SİSTEMLERİ

TEE (Socket Joint)-(Ready Made)  
TE (Geçme Muflu)-(Konfeksiyon)  
ПВХ тройник (с раструбным соединением  
под резиновое кольцо - конфекционный )

مشترک بطریقہ بدویہ



ITEM CODE	Ød(mm)
Kod No	Ød(mm)
01024063	63
01024075	75
01024090	90
01024110	40

REDUCTION TEE  
REDÜKSİYON TE  
Тройник Редукционный  
مشترک نقاص بطریقہ بدویہ

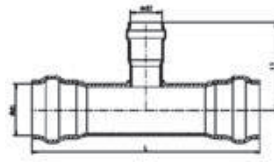

ITEM CODE	Ød1/Ød2	L1(mm)	L(mm)
Kod No	Ød1Ød2	L1(mm)	L(mm)
010292500110	250/110	290	630
010292500160	250/160	310	630
010293150110	315/110	310	700
010293150160	315/160	367	750
010294000110	400/110	350	840
010294000160	400/160	410	890
010295000110	500/110	400	990
010295000160	500/160	460	990
010296300110	630/110	465	1130
010296300160	630/160	525	1130

REDUCER (Solvent Cement Joint)  
REDÜKSİYON YAPIŞTIRMA  
ПВХ муфта переходная  
(клеевое соединение)  
نقاص

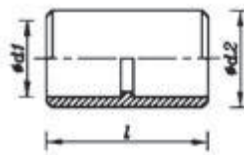

ITEM CODE	Ød1(mm)	Ød2(mm)	l(mm)
Kod No	Ød1(mm)	Ød2(mm)	l(mm)
01019025	25	20	50
01019032	32	25	54
01019040	40	32	52
01019050	50	40	72
01019063	63	50	92
01019075	75	63	92
01019090	90	75	107
01019110	110	90	134
01019125	125	110	
01019140	140	125	
01019160	160	140	

Note: Pressure rating is 16 bar.  
Not: Basınç sınıfı PN 16'dir.

PVC-U PRESSURE PIPE SYSTEMS / PVC-U BASINÇLI BORU SİSTEMLERİ

ITEM CODE	Ød1(mm)	R"	Ød2(mm)	sw	l(mm)
Kod No	Ød1(mm)	R"	Ød2(mm)	sw	l(mm)
01002020	20	1/2"	-	22	56
01002025	25	3/4"	-	27	62
01002032	32	1"	25	36	59
01002040	40	1 1/4"	32	44	65
01002050	50	1/2"	40	52	71
01002063	63	2"	-	64	116
01002075	75	2 1/2"	63	76	136
01002090	90	3"	75	90	152

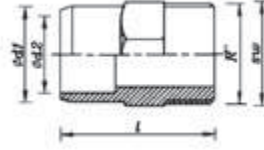

MALE ADAPTOR  
ADAPTÖR (Dıştan Paso)  
ПВХ адаптор с н.р.  
محول ذكر



\*d1 side of these adaptors can be solvent cement joint as well.  
\*Bu adaptörlerin d1 çaplı tarafı yapıştırma olarak kullanılır.  
Note: Pressure rating is 16 bar.  
Note: Basınç sınıfı PN 16' dir.

ITEM CODE	Ødmm	R"	l(mm)
Kod No	Ødmm	R"	l(mm)
01002110	110*	4"	182
01002125	125*	4 1/2"	182
01002140	140*	5"	202
01002160	160*	6"	242
01002200	200*	7"	-
01002225	225*	8"	-
01002250	250*	9"	-

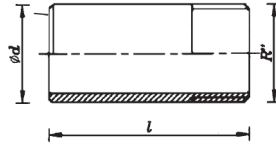

MALE ADAPTOR  
ADAPTÖR (Dıştan Paso)  
ПВХ адаптор с н.р.  
محول ذكر



\*These adaptors can be used with both socket weld joint pipes and solvent cement joint pipes.  
\*Bu adaptörler geçme muflu ve aynı zamanda yapıştırma muflu borularla da kullanılabilir.  
Note: Pressure rating is 16 bar.  
Note: Basınç sınıfı PN 16' dir.

ITEM CODE	Ød1(mm)	R"	Ød2(mm)	sw	l(mm)
Kod No	Ød1(mm)	R"	Ød2(mm)	sw	l(mm)
01003020	20	1/2"	25	32	40
01003025	25	3/4"	32	36	45
01003032	32	1"	40	46	50
01003040	40	1 1/4"	50	58	72
01003050	50	1/2"	63	68	86
01003063	63	2"	-	-	101

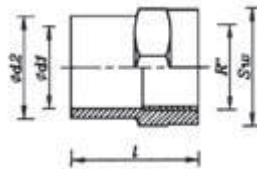

FEMALE ADAPTOR  
ADAPTÖR (İçten Paso)  
ПВХ адаптор с вн.р.  
محول انثى



\*These adaptors can be used with both socket weld joint pipes and solvent cement joint pipes.  
\*Bu adaptörler geçme muflu ve aynı zamanda yapıştırma muflu borularla da kullanılabilir.  
Note: Pressure rating is 16 bar.  
Note: Basınç sınıfı PN 16' dir.

PVC-U PRESSURE PIPE SYSTEMS / PVC-U BASINÇLI BORU SİSTEMLERİ

FEMALE ADAPTOR  
DİŞİ ADAPTÖR ( İçten Paso)

ПВХ адаптор с вн.р.  
محول

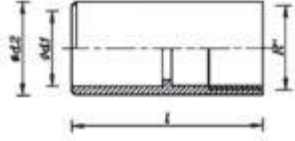

ITEM CODE	Ød1(mm)	R"	Ød2(mm)	l(mm)
Kod No	Ød1(mm)	R"	Ød2(mm)	l(mm)
01003020	20	1/2"	-	56
01003025	25	3/4"	-	62
01003032	32	1"	25	59
01003040	40	1 1/4"	32	65
01003050	50	1 1/2"	40	71
01003063	63	2"	-	116
01003075	75	2 1/2"	63	136
01003090	90	3"	75	152
01003110	110	4"	-	-
01003125	125	4 1/2"	-	-
01003140	140	5"	-	-
01003160	160	6"	-	-
01003200	200	7"	-	-

\*d2 end of these adaptors can be socket joint as well.  
\*Bu adaptörlerin d2 çapı geçme muflu olarak kullanılabilir.  
Note: Pressure rating is 16 bar.  
Not: Basınç sınıfı PN 16'dır.

NIPPEL  
NİPEL

ПВХ ниппель  
وصلة مسنن

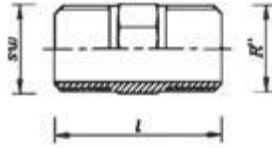

ITEM CODE	R"	l1(mm)	sw
Kod No	R"	l1(mm)	sw
01018020	1/2"	45	22
01018025	3/4"	49	27
01018032	1"	58	36

Note: Pressure rating is 16 bar.  
Not: Basınç sınıfı PN 16'dır.

SADDLE  
TAKIM KOLYE

ПВХ седло  
مخرج

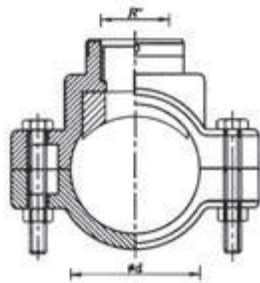

ITEM CODE	Ød(mm)	R"
Kod No	Ød(mm)	R"
010120320020	32	1/2"
010120320025	32	3/4"
010120400020	40	1/2"
010120400025	40	3/4"
010120500020	50	1/2"
010120500025	50	3/4"
010120500032	50	1"
010120630020	63	1/2"
010120630025	63	3/4"
010120330032	63	1"
010120750020	75	1/2"
010120750025	75	3/4"
010120750032	75	1"
010120900020	90	1/2"
010120900025	90	3/4"
010120900032	90	1"
010121100020	110	1/2"
010121100025	110	3/4"
010121100032	110	1"

Note: Pressure ratings is 10 bar.  
Not: Basınç sınıfı PN 10'dır

ITEM CODE	R"
Kod No	R"
01012020	1/2"
01012025	3/4"
01012032	1"

SADDLE APPARATUS (Cutter)  
KOLYE DELME APARATI  
Фреза для ПВХ труб  
مشقب يدوي



ITEM CODE	Ø(mm)
Kod No	Ø(mm)
01014020 YM	20
01014025 YM	25
01014032 YM	32
01014040	40
01014050	50
01014063	63
01014075	75
01014090	90
01014110	110
01014125	125
01014140	140
01014160	160

END PLUG (Solvent Cement Joint)  
KÖRTAPA (Yapıştırımalı)  
ПВХ заглушка (клеевое соединение)

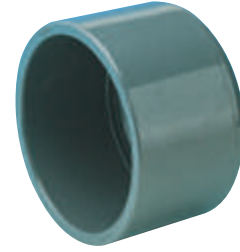

ITEM CODE	Ødmm	PN(Bar)	l(mm)
Kod No	Ødmm	Basınç Sınıfı(bar)	l(mm)
01014110 DM	110	10	85
01014160 DM	160	10	116

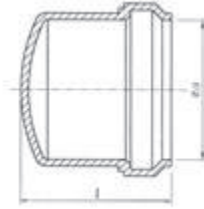

END PLUG (Socket Joint)  
KÖRTAPA (Geçme Muflu)  
ПВХ заглушка (с раструбом соединением под резиновое кольцо)

ITEM CODE	Ødmm	PN(Bar)	l(mm)
Kod No	Ødmm	Basınç Sınıfı(bar)	l(mm)
01014110 DY	110	10	85
01014160 DY	160	10	116

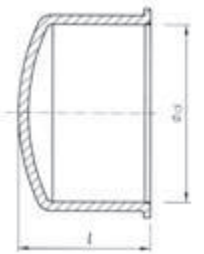

END PLUG (Solvent Cement Joint)  
KÖRTAPA (Yapıştırma Muflu)  
ПВХ заглушка (клеевое соединение)

PVC-U PRESSURE PIPE SYSTEMS / PVC-U BASINÇLI BORU SİSTEMLERİ

MALE END PLUG  
ERKEK KÖRTAPA  
ПВХ заглушка с н.р.  
سدة ذكّر

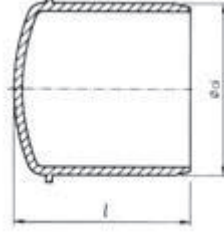

ITEM CODE	Ødmm	PN(Bar)	l(mm)
Kod No	Ødmm	Basınç Sınıfı(bár)	l(mm)
01014110 E 06	110	6	132
01014160 E 06	160	6	160

ITEM CODE	Ødmm	PN(Bar)	l(mm)
Kod No	Ødmm	Basınç Sınıfı(bár)	l(mm)
01014110 E 10	110	10	132
01014160 E 10	160	10	160

FLANGE  
FLANŞ  
Фланец  
فلانج



ITEM CODE	Ø(mm)
Kod No	Ø(mm)
01009020*	20
01009025*	25
01009032*	32
01009040*	40
01009050*	50
01009063*	63
01009075*	75
01009090*	90
01009110*	110
01009125*	125
01009140*	140
01009160*	160
01009200*	200
01009250*	250
01009280*	280
01009315*	315
01009355*	355
01009400*	400

Note: Between 20-200 mm, pressure bar is 16 and between 20-400 mm, pressure bar is 10  
Not: Basınç sınıfı Ø20 - Ø200 mm arası PN 16' dir. Ø200 - Ø400 mm arası PN 10' dur.

STUBEND  
KOLE  
ПВХ адаптор под фланец  
جوان فلانج



ITEM CODE	Ø(mm)
Kod No	Ø(mm)
01010020*	20
01010025*	25
01010032*	32
01010040*	40
01010050*	50
01010063*	63
01010075*	75
01010090*	90
01010110*	110
01010125*	125
01010140*	140
01010160*	160
01010200*	200
01010250*	250
01010280*	280
01010315*	315
01010355*	355
01010400*	400

Note: \*Marked items can be procured upon request.  
Not: Üretim setimizde olmayan ve \* ile belirtilen ürünler talep edildiğinde temin edilebilir.  
Note: Between 20-200 mm, pressure bar is 16 and between 20-400 mm, pressure bar is 10  
Not: Basınç sınıfı Ø20 - Ø200 mm arası PN 16' dir. Ø200 - Ø400 mm arası PN 10' dur.



PVC-U PRESSURE PIPE SYSTEMS / PVC-U BASINÇLI BORU SİSTEMLERİ

**THREADED TRANSITION  
RAKOR (Bir Tarafı Dişli)**  
ПВХ муфта разъемная  
с вн.р. (одна сторона)  
محول انشى طرف واحد مسنن



ITEM CODE	Size(mm)
Kod No	Çap(mm)
01022001020*	20
01022001025*	25
01022001032*	32
01022001040*	40
01022001050*	50
01022001063*	63
01022001075*	75
01022001090*	90
01022010110*	110

**TRANSITION MUFF  
RAKOR (Yapıştırma)**  
ПВХ муфта разъемная  
(клеевое соединение)  
محول تلتصيق



ITEM CODE	Size(mm)
Kod No	Çap(mm)
01022020*	20
01022025*	25
01022032*	32
01022040*	40
01022050*	50
01022063*	63
01022075*	75
01022090*	90
01022110*	110

**SPHERICAL VALVE  
KÜRESEL VANA**  
ПВХ кран шаровой  
صمام كروي



ITEM CODE	Size(mm)
Kod No	Çap(mm)
01026020*	20
01026025*	25
01026032*	32
01026040*	40
01026050*	50
01026063*	63
01026075*	75
01026090*	90

**VALVE  
ÇEK VALF**  
ПВХ муфта разъемная двойная  
صمام



ITEM CODE	Size(mm)
Kod No	Çap(mm)
01004020*	20
01004040*	40
01004050*	50
01004063*	63
01004075*	75
01004090*	90
01004110*	110
01004125*	125
01004140*	140
01004160*	160

**V GASKET  
V CONTA**  
Уплотнительное кольцо для  
водопроводной трубы ПВХ  
جوان



ITEM CODE	Size(mm)
Kod No	Çap(mm)
01031050	50
01031063	63
01031075	75
01031090	90
01031110	110
01031125	125
01031140	140
01031160	160
01031200	200
01031225	225
01031250	250
01031280	280
01031315	315
01031355	355
01031400	400
01031500	500
01031630	630
01031710	710
01031800	800
01031900	900
010311000	1000

**FLANGED SPHERICAL VALVE  
FLANŞLI KÜRESEL VANA**  
ПВХ кран шаровой с фланцем  
صمام مع فلانج

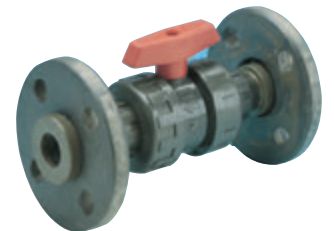

ITEM CODE	Size(mm)
Kod No	Çap(mm)
01027020*	20
01027025*	25
01027032*	32
01027040*	40
01027050*	50
01027063*	63
01027075*	75
01027090*	90
01027110*	110
01027125*	125
01027140*	140
01027160*	160

Note: \*Marked items can be procured upon request.

Not: Üretim setimizde olmayan ve "\*" ile belirtilen ürünler talep edildiğinde temin edilebilir.

# SEWER SYSTEMS

## KANALİZASYON BORU VE EK PARÇALARI

### Application Areas:

SDR 51 pipes; outside of buildings. SDR 41 and SDR 34 pipes are used in both outside and inside, underground of buildings.

### Uygulama Alanı:

SDR 51 borular; bina dışı uygulamalarda SDR 41 ve SDR 34 borular; bina içi yere gömülü ve bina dışı uygulamaların her ikisinde kullanılır.

### Ring Stiffness Value:

SN 2, SN 4, SN 8 definitions of the pipes in the tables show the ring stiffness value of the pipes 2, 4, 8 in KN/m<sup>2</sup>, respectively.

### Üst Yükleme Değeri:

Tablolardaki SN 2, SN 4 ve SN 8 değerleri KN/m<sup>2</sup> birimi cinsinden boruların çember rijitlik değerlerini ifade eder.

### Color:

Orange Brown (RAL 8023)

### Renk:

Turuncumsu Kahverengi (yaklaşık olarak RAL 8023)



TS EN ISO 9001:2000

SEWER SYSTEMS / KANALİZASYONBORU VE EK PARÇALARI

PVC-U SEWER PIPES  
PVC-U KANALİZASYON BORUSU  
ПВХ труба для наружной безнапорной  
канализации раструбная с кольцом  
مواسير يو - بي - في - سي للصرف الصحي

**SN2 SDR 51**

ITEM CODE	Ød (mm)	Bell Length (mm)	Wall Thickness (mm)	Unit Weight (kg/mt)
Kod No	Ød (mm)	Muf Boyu KT(mm)	Et Kalınlığı (mm)	Muflu Ağırlık (kg/mt)
23001110	110	130	3,2	1,679
23001125	125	140	3,2	1,856
23001160	160	165	3,2	2,399
23001200	200	185	3,9	3,782
23001250	250	210	4,9	5,784
23001315	315	230	6,2	9,265
23001355	355	240	7,0	11,824
23001400	400	260	7,9	15,128
23001450	450	280	8,8	20,643
23001500	500	300	9,8	24,083
23001630	630	335	12,3	38,790
23001710	710	420	13,9	50,369
23001800	800	430	15,7	63,749
23001900	900	450	17,6	81,038
230011100	1100	470	19,6	100,460

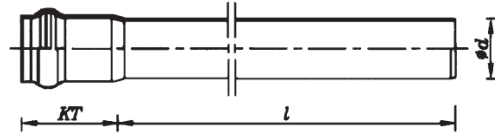

**SN4 SDR 41**

ITEM CODE	Ød (mm)	Bell Length (mm)	Wall Thickness (mm)	Unit Weight (kg/mt)
Kod No	Ød (mm)	Muf Boyu KT(mm)	Et Kalınlığı (mm)	Muflu Ağırlık (kg/mt)
23001110 SDR 41	110	130	3,2	1,679
23001125 SDR 41	125	140	3,2	1,856
23001160 SDR 41	160	165	4,0	3,080
23001200 SDR 41	200	185	4,9	4,722
23001250 SDR 41	250	210	6,2	7,484
23001315 SDR 41	315	230	7,7	11,739
23001355 SDR 41	355	240	8,7	14,926
23001400 SDR 41	400	260	9,8	19,085
23001450 SDR 41	450	280	11,0	24,153
23001500 SDR 41	500	300	12,3	30,072
23001630 SDR 41	630	335	15,4	47,676
23001710 SDR 41	710	420	17,4	60,949
23001800 SDR 41	800	430	19,6	77,987
23001900 SDR 41	900	450	22,0	98,646
230011100 SDR 41	1100	470	24,5	122,494

**SN8 SDR 34**

ITEM CODE	Ød (mm)	Bell Length (mm)	Wall Thickness (mm)	Unit Weight (kg/mt)
Kod No	Ød (mm)	Muf Boyu KT(mm)	Et Kalınlığı (mm)	Muflu Ağırlık (kg/mt)
23001110 SDR 34	110	130	3,2	1,679
23001125 SDR 34	125	140	3,7	2,200
23001160 SDR 34	160	165	4,7	3,582
23001200 SDR 34	200	185	5,9	5,647
23001250 SDR 34	250	210	7,3	8,762
23001315 SDR 34	315	230	9,2	13,930
23001355 SDR 34	355	240	10,4	17,694
23001400 SDR 34	400	260	11,7	22,472
23001450 SDR 34	450	280	13,2	28,893
23001500 SDR 34	500	300	14,6	35,480
23001630 SDR 34	630	335	18,4	56,816
23001710 SDR 34	710	420	*20,7	72,337
23001800 SDR 34	800	430	*23,3	92,130
23001900 SDR 34	900	450	*26,3	118,693
230011100 SDR 34	1100	470	*29,2	145,061

Note: SN 8 Class Pipes are not in the scope of EN 1401 for 710 mm and bigger Outside Diameters. They are manufactured on request.

Not: \* dış çap 710 ve üzeri SN 8 sınıfı borular standart kapsamında olmayıp, özel olarak üretilmektedir.

SEWER SYSTEMS / KANALİZASYONBORU VE EK PARÇALARI

SN8 PVC-U SEWER COLLAR SLEEVE  
SN8 PVC-U KANAL KAYAR MANŞON  
ПВХ муфта для безнапорной канализации  
وطة

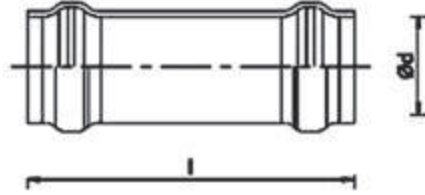

ITEM CODE	Ød(mm)	l(mm)
Kod No	Ød(mm)	l(mm)
23017110	110	290
23017125	125	290
23017160	160	300
23017200	200	370
23017250	250	480
23017315	315	605
23017355	355	610
23017400	400	680
23017500	500	810
23017630	630	830

SN8 PVC-U SEWER BEND  
SN8 PVC-U KANAL DEVE BOYNU 45°  
ПВХ отвод 45° для  
безнапорной канализации  
45 عاكس

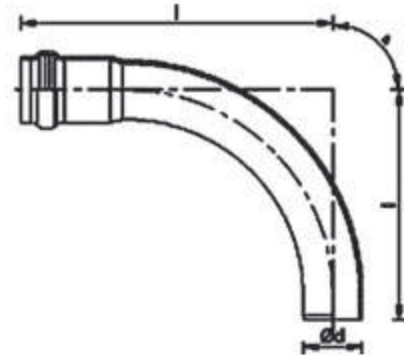

ITEM CODE	Ød(mm)	l(mm) 45°
Kod No	Ød(mm)	l(mm) 45°
23061100045	110	290
23061250045	125	290
23061600045	160	300
23062000045	200	370
23062500045	250	480
23063150045	315	605
23063550045	355	610
23066400045	400	680
23066500045	500	810

SEWER SYSTEMS / KANALİZASYONBORU VE EK PARÇALARI

SN8 PVC-U SEWER BEND  
SN8 PVC-U KANAL DEVE BOYNU 90°  
ПВХ отвод 90° для безнапорной  
канализации  
90° عاكس

ITEM CODE	Ød(mm)	l(mm)
Kod No	Ød(mm)	l(mm)
230061100090	110	562
230061250090	125	628
230061600090	160	796
230062000090	200	971
230062500090	250	1190
230063150090	315	1467
230063550090	355	1628
230064000090	400	1823
230065000090	500	2250

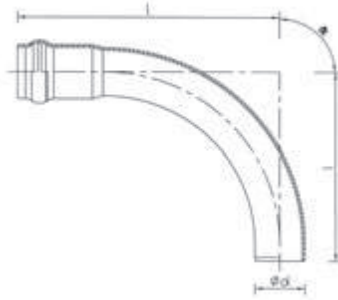

TEE (Socket Joint)  
TE (Geçme Muflu)  
Тройник (с раструбным соединением  
под резиновое кольцо)  
مشترك نقاص بطريقه الحقن

ITEM CODE	Ød(mm)	Ød1(mm)	l(mm)	l1(mm)
Kod No	Ød(mm)	Ød1(mm)	l(mm)	l1(mm)
230291600110	160	110	432	193
230291600160	160	160	432	215
230292000110	200	110	455	213
230292000160	200	160	455	235

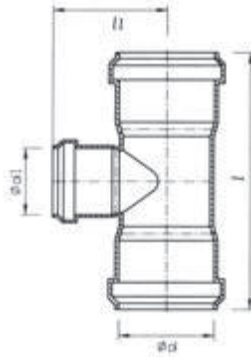

SN8 PVC-U SEWER TEE  
SN8 PVC-U KANAL TE  
ПВХ тройник для безнапорной  
канализации  
تي

ITEM CODE	Ød1/Ød2	l1(mm)	l(mm)
Kod No	Ød1/Ød2	l1(mm)	l(mm)
230292500110	250/110	290	630
230292500160	250/160	310	630
230293150110	315/110	310	700
230293150160	315/160	367	750
230294000110	400/110	350	840
230294000160	400/160	410	890
230295000110	500/110	400	990
230295000160	500/160	460	990
230296300110	630/110	465	1130
230296300160	630/160	525	1130

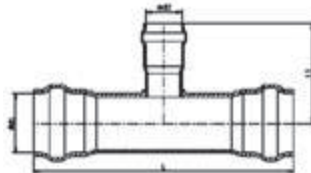



SEWER SYSTEMS / KANALİZASYONBORU VE EK PARÇALARI

MALE END PLUG  
SN8 PVC-U ERKEK KÖRTAPA  
ПВХ заглушка для безнапорной  
канализации  
سدة ذكر



ITEM CODE	Ød(mm)	l(mm)
Kod No	Ød(mm)	l(mm)
23014110 E 06	110	132
23014160 E 06	160	160

ITEM CODE	Ød(mm)	l(mm)
Kod No	Ød(mm)	l(mm)
23014110 E 10	110	132
23014160 E 10	160	160

SN8 PVC-U END PLUG (Socket Joint)  
SN8 PVC-U KÖRTAPA (Geçme Muflu)  
ПВХ заглушка для безнапорной канализации  
(раструбное соединение с уплотнительным кольцом)  
سدة نهايه خط (جوان)



ITEM CODE	Ød(mm)	l(mm)
Kod No	Ød(mm)	l(mm)
23014110 DM	110	131
23014160 DM	160	174

SN8 PVC-U END PLUG (Solvent Cement Joint)  
SN8 PVC-U KÖRTAPA (Yapıştırma Muflu)  
ПВХ заглушка для безнапорной  
канализации (клеевое соединение)  
سدة نهايه خط تلتصيق



ITEM CODE	Ød(mm)	l(mm)
Kod No	Ød(mm)	l(mm)
23014110 DM	110	85
23014160 DM	160	116



# EGE CORRUGATED PIPES & FITTINGS

## EGE KORUGE BORU VE EK PARÇALARI

- ◆ Yüksek akış performansı
  - ◆ Dış yüklerle karşı üstün dayanıklılık
  - ◆ Uzun çalışma ömrü
  - ◆ Hafif olması nedeniyle taşıma ve stoklama kolaylığı
  - ◆ Esnek sızdırmaz yer sarsıntılarından etkilenmez
  - ◆ Ekonomik
  - ◆ Kimyasal maddelere karşı dayanıklılık
  - ◆ Bakım kolaylığı
  - ◆ Firesiz çalışma imkanı
- ◆ High fluidity performance
  - ◆ Long working life
  - ◆ Easiness of handling and stocking due to its light weight
  - ◆ Free from earthquake effects and leakage
  - ◆ Economic
  - ◆ Resistant to chemicals
  - ◆ Easy to repair



TS EN ISO 9001:2000

## EGE CORRUGATED PIPES AND FITTINGS

*Raw Material:* HDPE (High Density Polyethylene)

*Fields in use:*

- Sewage lines
- Drainage lines
- Rainwater lines
- Industrial sewer lines
- Home sewer lines

*Advantages:*

- High fluidity performance
- Long working life
- Free from earthquake effects and leakage
- Economic
- Resistant to chemicals
- Easy to repair
- Easiness of handling and stocking due to its light weight

*Production Range:* Inside diameter 150-200-300-400-500 mm

*Types of Pipes:* Ring stiffness value of production is in both SN4 and SN8 classes.

*Related Standarts:* According to EN ISO 13476-3

*Connection Type:* Pipes and fittings are connected with rubber ring socket joint method.

*Fields of Use:* In Sewer Systems there is-non pressure flow of water. Pipes are faced with external loading. Therefore, type of soil and traffic are criterias to select the type of pipe. Related installation standarts have to be applied for underground Sewer Systems.

## EGE KORUGE BORU VE EK PARÇALARI

*Hammaddesi:* HDPE (Yüksek Yoğunluklu Polietilen)

*Kullanım Sahası:*

- Kanalizasyon hatları
- Drenaj ve toprak zemin sularını taşıma hatları
- Yağmur suyu hatları
- Sanayi ve endüstriyel atık su hatları
- Eysel atık sularını uzaklaştırma hatlarında kullanılır.

*Üretim Aralığı:* İç çap 150 – 200 – 300 – 400 – 500 mm olarak üretimi mevcuttur.

*Boru Tipleri:* Üst yükleme sınıfları (Ring stiffness value) SN 4 ve SN 8 kN/m<sup>2</sup> olmak üzere iki sınıfta üretilmektedir.

*İlgili Standart:* EN ISO 13476-3'e uygun olarak üretilmektedir.

*Birleştirme şekilleri:* Boru ve ek parçalar contalı geçme yöntemi ile birleştirilir.

*Uygulama:* Kanalizasyon sistemlerinde basınçlı olmayan cazibeli (serbest) bir akış söz konusudur. Dolayısı ile borular toprak altında dış yüklerle maruz kalırlar. Bu nedenle toprak ve trafik yükü gibi dış yüklerin etkisi çok önem kazanır. Bu yükler analiz edilerek boru tipinin seçimi yapılmalıdır. Atık su kanalizasyon sistemlerinde toprak altında yapılan boru uygulamalarında döşeme kurallarına uyulmalıdır.

EGE CORRUGATED PIPE / EGE KORUGE BORU

EGE CORRUGATED PIPE, INSIDE YELLOW  
EGE KORUGE BORU SARI  
"EGE" желтая гофрированная труба



**SN 4**

ITEM CODE	Size(mm)
Kod No	Çap(mm)
240001506000 S4	150
240002006000 S4	200
240003006000 S4	300
240004006000 S4	400
240005006000 S4	500

EGE CORRUGATED PIPE, INSIDE YELLOW  
EGE KORUGE BORU SARI  
"EGE" желтая гофрированная труба



**SN 8**

ITEM CODE	Size(mm)
Kod No	Çap(mm)
240001506000 S8	150
240002006000 S8	200
240003006000 S8	300
240004006000 S8	400
240005006000 S8	500

GASKET  
KORUGE CONTA  
Прокладка

ITEM CODE	Size(mm)
Kod No	Çap(mm)
24031150	150
24031200	200
24031300	300
24031400	400
24031500	500

EGE CORRUGATED PIPE, INSIDE BLUE  
EGE KORUGE BORU MAVİ  
"EGE" голубая гофрированная труба

**SN 4**

ITEM CODE	Size(mm)
Kod No	Çap(mm)

240011506000 M4	150
240012006000 M4	200
240013006000 M4	300
240014006000 M4	400
240015006000 M4	500



EGE CORRUGATED PIPE, INSIDE BLUE  
EGE KORUGE BORU MAVİ  
"EGE" голубая гофрированная труба

**SN 8**

ITEM CODE	Size(mm)
Kod No	Çap(mm)

240011506000 M8	150
240012006000 M8	200
240013006000 M8	300
240014006000 M8	400
240015006000 M8	500





SOCKET  
MANŞON  
Муфта



ITEM CODE	Size(mm)
Kod No	Çap(mm)
24015150	150
24015200	200
24015300	300
24015400	400
24015500	500

ELBOW  
KORUGE 87,5 DİRSEK  
Колено



ITEM CODE	Size(mm)
Kod No	Çap(mm)
24038150	150
24038200	200
24038300	300
24038400	400
24038500	500

REDUCTION  
KORUGE REDÜKSİYON  
Муфта переходная



ITEM CODE	Size(mm)
Kod No	Çap(mm)
240191500100	150x100
240192000150	200x150
240192000100	200x100
240193000200	300x200
240193000150	300x150
240194000200	400x200
240194000150	400x150
240194000300	400x300
240195000400	500x400

SINGLE BRANCH  
KORUGE TEK ÇATAL PVC ÇIKIŞ  
Тройник



ITEM CODE	Size(mm)
Kod No	Çap(mm)
24030150100150P	150x100x150
24030150150150P	150x150x150
24030200100200P	200x100x200
24030200150200P	200x150x200
24030200200200P	200x200x200
24030300100300P	300x100x300
24030300150300P	300x150x300
24030300200300P	300x200x300

ITEM CODE	Size(mm)
Kod No	Çap(mm)
240291500100	150x100
240291500150	150x150
240292000100	200x100
240292000150	200x150
240292000200	200x200
240293000100	300x100
240293000150	300x150
240293000200	300x200
240293000300	300x300
240293000100	300x100
240294000150	400x150
240294000200	400x200
240294000300	400x300
240294000400	400x400
240295000400	500x400
240295000500	500x500

TEE BRANCH  
KORUGE TE ÇATAL  
Тройник угловой



TEE BRANCH  
KORUGE TEK ÇATAL C PARÇASI  
Тройник угловой

ITEM CODE	Size(mm)
Kod No	Çap(mm)
24030150100150	150x100x150
24030200100200	200x100x200
24030200150200	200x150x200
24030200200200	200x200x200
24030300200300	300x200x300
24030300150300	300x150x300
24030300100300	300x100x300
24030400100400	400x100x400
24030400150400	400x150x400
24030400200400	400x200x400
24030400300400	400x300x400
24030400400400	400x400x400



ELBOW 45  
KORUGE 45 DİRSEK  
Колено

ITEM CODE	Size(mm)
Kod No	Çap(mm)
24037150	150
24037200	200
24037300	300
24037400	400
24037500	500



**POLYETHYLENE (PE)  
SYSTEMS**

**POLİETİLEN  
BORU SİSTEMLERİ**

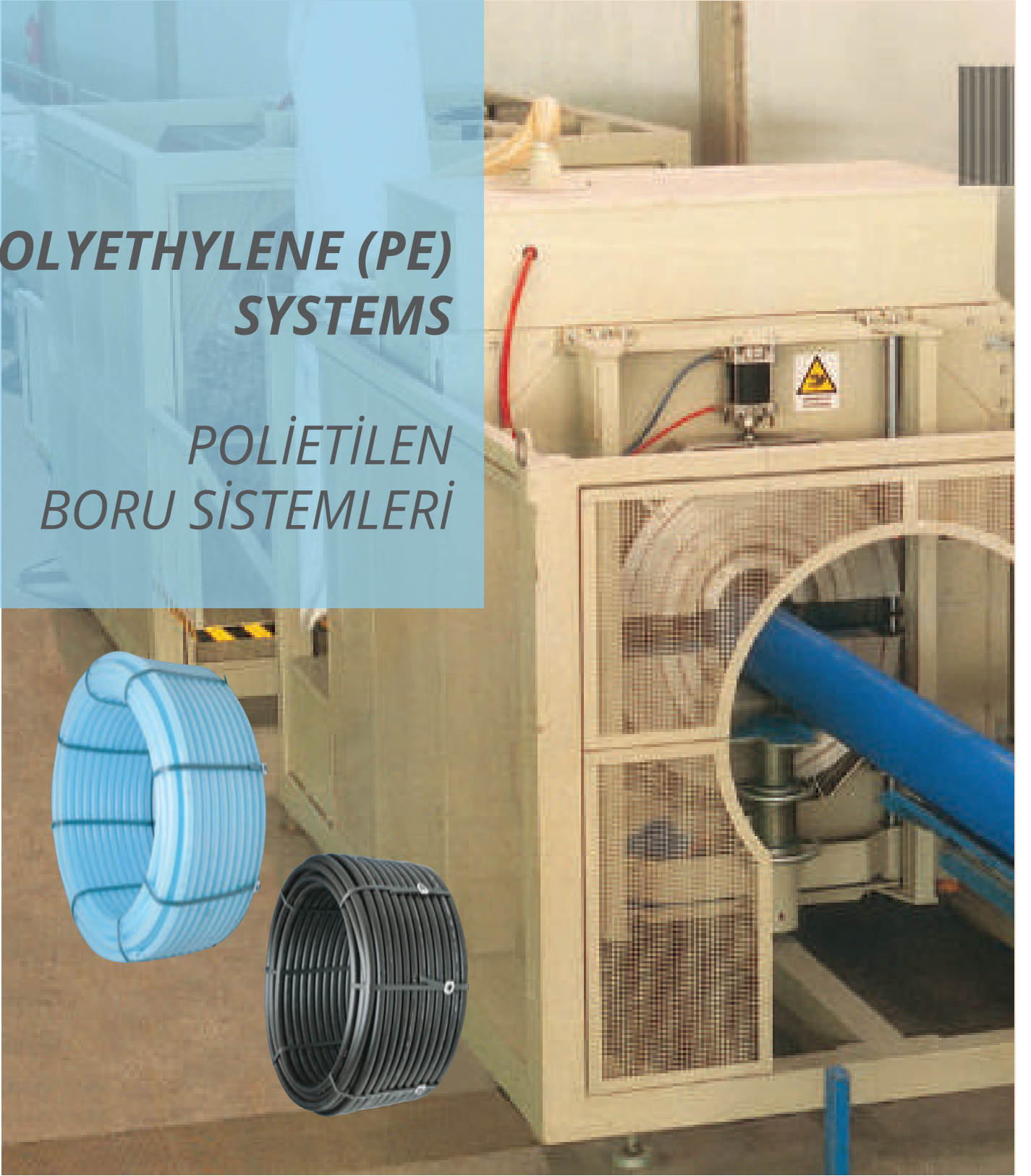

TS EN ISO 9001:2000

## POLYETHYLENE (PE) SYSTEMS

Egeplast manufactures LDPE and HDPE pipes for potable water systems at various sizes between Ø20-Ø630 mm.

Egeplast manufactures PE pipes for potable water systems from different grade PE resins between Ø20-Ø630 mm sizes. Complementary PE fittings are also available. Due to its general characteristics PE pipes are one of the best alternative for pressurized pipe systems. Application areas are sea outfall projects, under and above ground water transportation networks, fish cages for fish farming industry etc. Polyethylene pipes shall be black for above ground applications.

## POLİETİLEN BORU SİSTEMLERİ

Egeplast'ın PE basınçlı temiz su sistemleri farklı sınıflarda polietilen hammaddelerden imal edilmiş, Ø20-Ø630 mm çaplar arası boruları ve tamamlayıcı ek parçalarını içermektedir.

Polietilenin temel özelliklerinden dolayı, basınçlı temiz su sistemlerinde kullanılan boru tipleri içerisinde iyi alternatiflerden biri Polietilendir.

Deniz deşarj projeleri ve yerüstü basınçlı su şebeke hatları, balık üretme çiftliği üretim kafesleri yapımında kullanılır.

Polietilen boruların yer üstünde kullanılması durumunda siyah renkleri kullanılmalıdır.

TS EN 12201-2 ve 12201-3 Standartına uygun olarak üretilmektedir.



POLYETHYLENE (PE) SYSTEMS / POLİETİLEN BORU SİSTEMLERİ

LDPE PE PIPES

AYPE PE 32 BORULAR

ПЭ 32 (LDPE - Полиэтилен низкой плотности)

انابيب بولي اثيلين منخفض الكثافة نوع بريش



PN SDR	2,5 BAR 21	3,2 BAR 17	4 BAR 13,6	5 BAR 11	6 BAR 9,4	8 BAR 7,4	10 BAR 6
Çap (mm)	s(mm) m (kg/mt)	s(mm) m (kg/mt)	s(mm) m (kg/mt)	s(mm) m (kg/mt)	s(mm) m (kg/mt)	s(mm) m (kg/mt)	s(mm) m (kg/mt)
16						2,3 0,101	3,0 0,124
20				2,0 0,113	2,2 0,124	2,3 0,127	3,4 0,174
25			2,5 0,145	2,3 0,164	2,7 0,188	3,5 0,232	4,2 0,269
32		2,0 0,190	2,4 0,223	3,0 0,270	3,5 0,310	4,4 0,372	5,4 0,439
40	2,0 0,240	2,4 0,283	3,0 0,345	3,7 0,415	4,3 0,475	5,5 0,580	6,7 0,679
50	2,4 0,363	3,0 0,439	3,7 0,530	4,6 0,643	5,4 0,741	6,9 0,906	8,4 1,060
63	3,0 0,561	3,8 0,697	4,7 0,844	5,8 1,017	6,8 1,170	8,6 1,422	10,5 1,670
75	3,6 0,801	4,5 0,979	5,6 1,194	6,8 1,419	8,1 1,660	10,3 2,023	12,5 2,360
90	4,3 1,150	5,4 1,406	6,7 1,710	8,2 2,048	9,7 2,370	12,3 2,898	15,0 3,400
110	5,3 1,720	6,6 2,903	8,1 2,523	10,0 3,047	11,8 3,520	15,1 4,339	18,3 5,090
125	6,0 2,190	7,4 2,666	9,2 3,253	11,4 3,942	13,4 4,550	17,1 2,584	20,8 6,560
140	6,7 2,750	8,3 3,344	10,3 4,075	12,7 4,917			
160	7,7 3,600	9,5 4,368	11,8 5,328	14,6 6,451			

NOTE: PE 32 Pipe are not in the scope of standart due to the changes by 30.03.2011  
NOT: 30.03.2011 tarihinden itibaren standartların değişmesi nedeniyle  
PE 32 borular standart kapsamından çıkarılmış olup, özel olarak üretilmektedir.

HDPE PE 80 PIPES

YYPE PE 80 BORULAR

ПЭ 80 (HDPE - полиэтилен высокой плотности)

انابيب بولي اثيلين متوسطه الكثافة للزراعة



PN SDR	3,2 BAR 41	4 BAR 33	5 BAR 26	8 BAR 17	10 BAR 13,6	12,5BAR 11	16 BAR 9	20 BAR 7,4	25 BAR 6
Çap (mm)	s(mm) m (kg/mt)	s(mm) m (kg/mt)	s(mm) m (kg/mt)	s(mm) m (kg/mt)	s(mm) m (kg/mt)	s(mm) m (kg/mt)	s(mm) m (kg/mt)	s(mm) m (kg/mt)	s(mm) m (kg/mt)
16							2,0 0,091	2,3 0,101	3,0 0,124
20						2,0 0,117	2,3 0,131	3,0 0,162	3,4 0,179
25					2,0 0,150	2,3 0,171	3,0 0,211	3,5 0,239	4,2 0,276
32				2,0 0,196	2,4 0,230	3,0 0,280	3,6 0,326	4,4 0,391	5,4 0,452
40				2,4 0,293	3,0 0,357	3,7 0,430	4,5 0,507	5,5 0,606	6,7 0,701
50				3,0 0,454	3,7 0,548	4,6 0,666	5,6 0,787	6,9 0,931	8,3 1,085
63				2,5 0,486	3,8 0,720	4,7 0,872	5,8 1,050	7,1 1,252	8,6 1,480
75				2,9 0,665	4,5 1,015	5,6 1,234	6,8 1,480	8,3 1,744	10,3 2,100
90				3,5 0,965	5,4 1,457	6,7 1,767	8,2 2,120	10,1 2,537	12,3 3,020
110				4,2 1,416	6,6 2,176	8,1 2,608	10,0 3,140	12,3 3,773	15,1 4,490
125				4,8 1,824	7,4 2,807	9,2 3,362	11,4 4,080	14,0 4,875	17,1 5,800
140				5,4 2,303	8,3 3,468	10,3 4,212	12,7 5,110	15,4 6,018	19,2 7,270
160				6,2 3,020	9,5 4,540	11,8 5,507	14,6 6,670	17,9 7,970	21,9 9,470
180				6,9 3,761	10,7 5,733	13,3 6,977	16,4 8,420	20,1 10,066	24,6 12,000
200				7,7 4,582	11,9 7,078	14,7 8,566	18,2 10,400	22,4 12,454	27,4 14,800
225				8,6 5,737	13,4 8,976	16,6 10,872	20,5 13,100	25,2 15,755	30,8 18,700
250				9,6 7,159	14,8 10,991	18,4 13,386	22,8 16,200	27,9 19,385	34,2 23,100
280				10,7 8,904	16,6 13,797	20,6 16,776	25,4 20,300	31,3 24,343	38,3 28,900
315	7,7 7,507	9,7 9,368	12,1 11,279	18,7 17,474	23,2 21,244	28,6 25,700	35,2 30,791	43,1 36,600	52,3 42,756
355	8,7 9,545	10,9 11,853	13,6 14,338	21,1 22,206	26,1 26,927	32,2 32,600	39,7 39,123	48,5 59,000	59,0 54,338
400	9,8 12,101	12,3 15,056	15,3 18,163	23,7 28,097	29,4 34,164	36,3 41,400	44,7 49,627	61,5 74,600	
450	11,0 15,266	13,8 18,990	17,2 22,949	26,7 35,592	33,1 43,255	40,9 52,400	50,3 62,810		
500	12,3 18,946	15,3 23,380	19,1 28,362	29,7 43,972	36,8 53,416	45,4 64,850	55,8 77,424		
560	13,7 23,621	17,2 29,414	21,4 35,538	33,2 55,041	41,2 66,964	50,8 81,462			
630	15,4 29,849	19,3 37,113	24,1 45,031	37,4 69,729	46,3 84,648	57,2 102,800			

POLYETHYLENE (PE) SYSTEMS / POLİETİLEN BORU SİSTEMLERİ

HDPE PE 100 PIPES  
YYPE PE 100 BORULAR  
ПЭ 100 (HDPE - полиэтилен высокой плотности)  
انابيب بولي اثيلين PE100

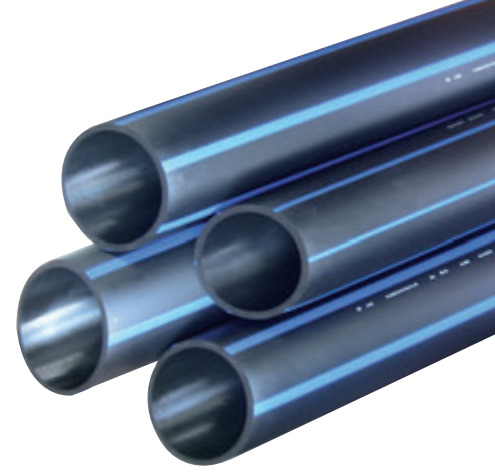

PN SDR Çap (mm)	4 BAR 41 s(mm) m (kg/mt)	5 BAR 33 s(mm) m (kg/mt)	6 BAR 26 s(mm) m (kg/mt)	8 BAR 21 s(mm) m (kg/mt)	10 BAR 17 s(mm) m (kg/mt)	12,5BAR 13,6 s(mm) m (kg/mt)	16 BAR 11 s(mm) m (kg/mt)	20 BAR 9 s(mm) m (kg/mt)	25 BAR 7,4 s(mm) m (kg/mt)
16								2,0 0,091	2,3 0,101
20							2,0 0,117	2,3 0,131	3,0 0,162
25						2,0 0,150	2,3 0,171	3,0 0,211	3,5 0,239
32					2,0 0,196	2,4 0,230	3,0 0,230	3,6 0,326	4,4 0,391
40				2,0 0,249	2,4 0,293	3,0 0,357	3,7 0,430	4,5 0,507	5,5 0,606
50			2,0 0,307	2,4 0,371	3,0 0,454	3,7 0,548	4,6 0,666	5,6 0,787	6,9 0,931
63			2,5 0,486	3,0 0,580	3,8 0,720	4,7 0,872	5,8 1,050	7,1 1,252	8,6 1,480
75			2,9 0,665	3,6 0,825	4,5 1,015	5,6 1,234	6,8 1,480	8,3 1,744	10,3 2,100
90			3,5 0,965	4,3 1,178	5,4 1,457	6,7 1,767	8,2 2,120	10,1 2,537	12,3 3,020
110			4,2 1,416	5,3 1,767	6,6 2,176	8,1 2,608	10,0 3,140	12,3 3,773	15,1 4,490
125			4,8 1,824	6,0 2,269	7,4 2,807	9,2 3,362	11,4 4,080	14,0 4,875	17,1 5,800
140			5,4 2,303	6,7 2,834	8,3 3,468	10,3 4,212	12,7 5,110	15,4 6,018	19,2 7,270
160			6,2 3,020	7,7 3,714	9,5 4,540	11,8 5,507	14,6 6,670	17,9 7,970	21,9 9,470
180			6,9 3,761	8,6 4,663	10,7 5,733	13,3 6,977	16,4 8,420	20,1 10,066	24,6 12,000
200			7,7 4,582	9,6 5,766	11,9 7,078	14,7 8,566	18,2 10,400	22,4 12,454	27,4 14,800
225			8,6 5,737	10,8 7,303	13,4 8,976	16,6 10,872	20,5 13,100	25,2 15,755	34,2 23,100
250			9,6 7,159	11,9 8,938	14,8 10,991	18,4 13,386	22,7 16,200	27,9 19,385	38,3 28,900
280			10,7 8,904	13,4 11,260	16,6 13,797	20,6 16,776	25,4 20,300	31,3 24,343	43,1 36,600
315	7,7 7,507	9,7 9,368	12,1 11,279	15,0 14,174	18,7 17,474	23,2 21,244	28,6 25,700	35,2 30,791	48,5 46,400
355	8,7 9,545	10,9 11,853	13,6 14,338	16,9 17,985	21,1 22,206	26,1 26,927	32,2 32,600	39,7 39,123	54,7 59,000
400	9,8 12,101	12,3 15,056	15,3 18,163	19,1 22,885	23,7 28,097	29,4 34,164	36,3 41,400	44,7 49,627	61,5 74,600
450	11,0 15,266	13,8 18,990	17,2 22,949	21,5 28,965	26,7 35,592	33,1 43,255	40,9 52,400	50,3 62,810	
500	12,3 18,946	15,3 23,380	19,1 28,362	23,9 35,760	29,7 43,972	36,8 53,416	45,4 64,850	55,8 77,424	
560	13,7 23,621	17,2 29,414	21,4 35,538	26,7 44,732	33,2 55,042	41,2 66,964	50,8 81,462		
630	15,4 29,849	19,3 37,113	24,1 45,031	30,0 56,526	37,4 69,729	46,3 84,648	57,2 102,800		



POLYETHYLENE (PE) SYSTEMS / POLİETİLEN BORU SİSTEMLERİ

SPIGOT REDUCING TE  
SPİGOT REDÜKSİYON TE  
ПЭ100 сварочные соединительные фитинги  
تي ناقص

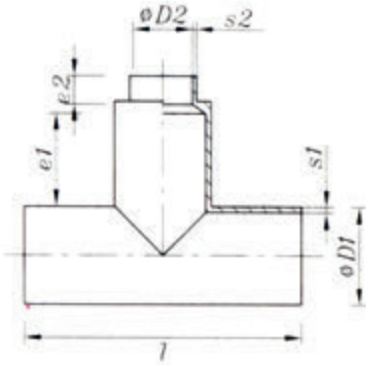

SN2 SDR 51

ITEM CODE	ØD1 (mm)	ØD2 (mm)	s1 (mm)	s2 (mm)	e1 (mm)	e2 (mm)	l (mm)
Kod No	ØD1 (mm)	ØD2 (mm)	s1 (mm)	s2 (mm)	e1 (mm)	e2 (mm)	l (mm)
18TRAA110090 S	110	90	6,60	5,40	150	150	410
18TRAA125090 S	125	90	7,40	5,40	150	152,5	430
18TRAA125110 S	125	110	7,40	6,60	150	152,5	430
18TRAA140090 S	140	90	8,30	5,40	150	150	440
18TRAA140110 S	140	110	8,30	6,60	150	150	440
18TRAA140125 S	140	125	8,30	7,40	150	150	440
18TRAA160090 S	160	90	9,50	5,40	150	150	460
18TRAA160110 S	160	110	9,50	5,40	150	150	460
18TRAA160125 S	160	125	9,50	7,40	150	150	460
18TRAA160140 S	160	140	9,50	8,30	150	150	460
18TRAA180090 S	180	90	10,70	5,40	150	150	480
18TRAA180110 S	180	110	10,70	7,40	150	150	480
18TRAA180125 S	180	125	10,70	7,40	150	150	480
18TRAA180140 S	180	140	10,70	9,50	150	150	480
18TRAA180160 S	180	160	10,70	9,50	150	150	480
18TRAA200090 S	200	90	11,90	5,40	150	150	500
18TRAA200110 S	200	110	11,90	6,60	150	150	500
18TRAA200125 S	200	125	11,90	6,60	150	150	500
18TRAA200140 S	200	140	11,90	8,30	150	150	500
18TRAA200160 S	200	160	11,90	9,50	150	150	500
18TRAA200180 S	200	180	11,90	10,70	150	150	500
18TRAA225090 S	225	90	13,40	5,40	150	153	530
18TRAA225110 S	225	110	13,40	6,60	150	153	530
18TRAA225125 S	225	125	13,40	7,40	150	153	530
18TRAA225140 S	225	140	13,40	8,30	150	153	530
18TRAA225160 S	225	160	13,40	9,50	150	153	530
18TRAA225180 S	225	180	13,40	10,70	150	153	530
18TRAA225200 S	225	200	13,40	10,70	150	153	530
18TRAA250090 S	250	90	14,80	5,40	150	250	750
18TRAA250110 S	250	110	14,80	6,60	150	250	750
18TRAA250125 S	250	125	14,80	7,40	150	250	750
18TRAA250140 S	250	140	14,80	8,30	150	250	750
18TRAA250160 S	250	160	14,80	9,50	150	250	750
18TRAA250180 S	250	180	14,80	10,70	150	250	750
18TRAA250200 S	250	200	14,80	11,90	150	250	750
18TRAA250225 S	250	225	14,80	13,40	150	250	750
18025280250S10	280	250	16,60	14,80			
18025315280S10	315	280	18,70	16,60			
18025355315S10	355	315	21,10	18,70			
18025355315S10	400	355	23,70	21,10			

SPIGOT EQUAL TEE  
SPİGOT EŞİT TE  
ПЭ тройник  
تي أنشئ

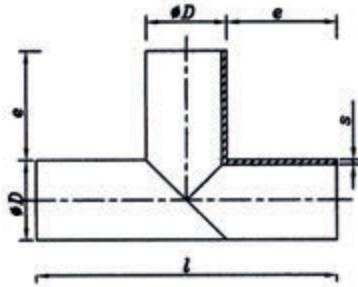

PE100 PN10

ITEM CODE	ØD1 (mm)	s (mm)	e (mm)	l (mm)
Kod No	ØD1 (mm)	s (mm)	e (mm)	l (mm)
18TEAA090 S	90	8,20	150	390
18TEAA110 S	110	10,00	150	410
18TEAA125 S	125	11,40	153	430
18TEAA140 S	140	12,70	150	440
18TEAA160 S	160	14,60	150	460
18TEAA180 S	180	16,40	150	480
18TEAA200 S	200	18,20	150	500
18TEAA225 S	225	20,50	153	530
18TEAA250 S	250	22,80	250	750
18025280 S 10	280	25,40		
18025315 S 10	315	28,60		
18025355 S 10	355	32,20		
18025400 S 10	400	36,30		
18025450 S 10	450	40,90		
18025500 S 10	500	45,40		

POLYETHYLENE (PE) SYSTEMS / POLİETİLEN BORU SİSTEMLERİ

SPIGOT ELBOW 90°  
SPİGOT DİRSEK 90°  
ПЭ угольник 90°  
90° كوع

**PE100 PN10**

ITEM CODE	ØD1 (mm)	s (mm)	e (mm)	b (mm)
Kod No	ØD1 (mm)	s (mm)	e (mm)	b (mm)
18DIAA090 90S	90	5,40	44	173
18DIAA110 90S	110	6,60	44	173
18DIAA125 90S	125	7,40	50	175
18DIAA140 90S	140	8,30	56	178
18DIAA160 90S	160	9,50	64	182
18DIAA180 90S	180	10,70	72	186
18DIAA200 90S	200	11,90	80	190
18DIAA225 90S	225	13,40	90	196
18DIAA250 90S	250	14,80	99	307
18DIAA280 90S	280	16,60	111	306
18DIAA315 90S	315	18,70	125	365
18008355090S	355	21,10		
18008400090S	400	23,70		
18008450090S	450	26,70		
18008500090S	500	29,70		

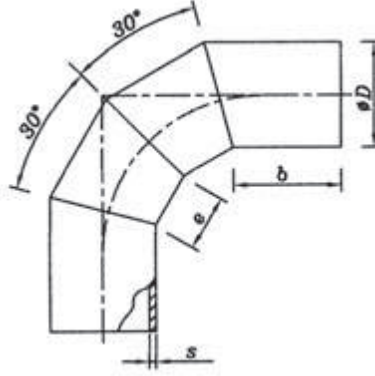

SPIGOT ELBOW 45°  
SPİGOT DİRSEK 45°  
ПЭ угольник 45°  
45° كوع

**PE100 PN10**

ITEM CODE	ØD1 (mm)	s (mm)	e (mm)	b (mm)
Kod No	ØD1 (mm)	s (mm)	e (mm)	b (mm)
18DIAA090 45S	90	5,40	44	173
18DIAA110 45S	110	6,60	44	173
18DIAA125 45S	125	7,40	50	175
18DIAA140 45S	140	8,30	56	178
18DIAA160 45S	160	9,50	64	182
18DIAA180 45S	180	10,70	72	186
18DIAA200 45S	200	11,90	80	190
18DIAA225 45S	225	13,40	90	196
18DIAA250 45S	250	14,80	99	307
18DIAA280 45S	280	16,60	111	306
18DIAA315 45S	315	18,70	125	365
18008355045 S10	355	21,10		
18008400045 S10	400	23,70		
18008450045 S10	450	26,70		
18008500045 S10	500	29,70		

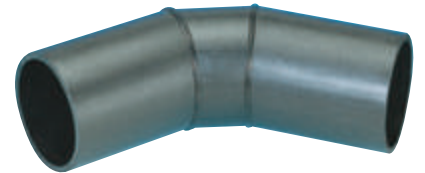
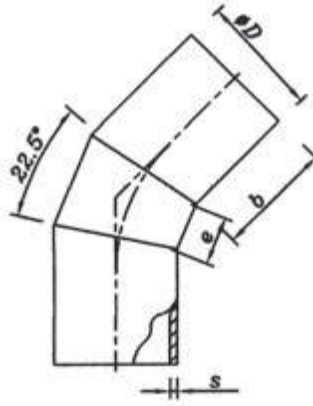

POLYETHYLENE (PE) SYSTEMS / POLİETİLEN BORU SİSTEMLERİ

SPIGOT STUB END (Short)  
SPİGOT FLANŞ ADAPTÖR (Kısa)  
ПЭ фланцевый адаптор (короткий)  
محول فلانج (قصير)

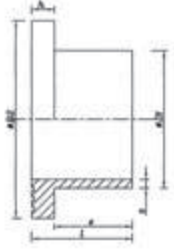

**PE100 PN10**

ITEM CODE	ØD1 (mm)	ØD2 (mm)	s (mm)	e (mm)	h (mm)	l (mm)
Kod No	ØD1 (mm)	ØD2 (mm)	s (mm)	e (mm)	h (mm)	l (mm)
18FPAA090 S	90	138	5,40	63	17	80
18FPAA110 S	110	158	6,60	62	18	80
18FPAA125 S	125	158	7,40	55	25	80
18FPAA140 S	140	188	8,30	55	25	80
18FPAA160 S	160	212	9,50	55	25	80
18FPAA180 S	180	212	10,70	50	30	80
18FPAA200 S	200	268	11,90	68	32	100
18FPAA225 S	225	268	13,40	68	32	100
18FPAA250 S	250	320	14,80	65	35	100
18FPAA280 S	280	320	16,60	65	35	100
18FPAA315 S	315	370	18,70	65	35	100
18015355 S10	355	430	21,10			
18015400 S10	400	482	23,70			
18015450 S10	450	585	26,70			
18015500 S10	500	585	29,70			

SPIGOT STUB END (Elongated)  
SPİGOT FLANŞ ADAPTÖR (Uzun)  
ПЭ фланцевый адаптор (длинный)  
محول فلانج (طويل)

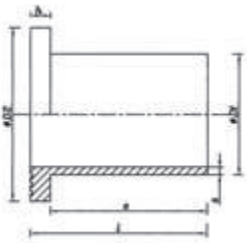

**PE100 PN10**

ITEM CODE	ØD1 (mm)	ØD2 (mm)	s (mm)	e (mm)	h (mm)	l (mm)
Kod No	ØD1 (mm)	ØD2 (mm)	s (mm)	e (mm)	h (mm)	l (mm)
18FPAA090 SS	90	138	5,40	123	17	140
18FPAA110 SS	110	158	6,60	142	18	160
18FPAA125 SS	125	158	7,40	145	25	170
18FPAA140 SS	140	188	8,30	175	25	200
18FPAA160 SS	160	212	9,50	175	25	200
18FPAA180 SS	180	212	10,70	170	30	200
18FPAA200 SS	200	268	11,90	168	32	200
18FPAA225 SS	225	268	13,40	168	32	200
18FPAA250 SS	250	320	14,80	215	35	250
18FPAA280 SS	280	320	16,60	215	35	250
18FPAA315 SS	315	370	18,70	215	35	250
18015355 S10	355	430	21,10			
18015400 S10	400	482	23,70			
18015450 S10	450	585	26,70			
18015500 S10	500	585	29,70			

POLYETHYLENE (PE) SYSTEMS / POLİETİLEN BORU SİSTEMLERİ

SPIGOT REDUCING TE  
SPİGOT REDÜKSİYON TE  
ПЭ переходник  
نقاص

PE100 PN10

ITEM CODE	ØD1 (mm)	ØD2 (mm)	s1 (mm)	s2 (mm)	e1 (mm)	e2 (mm)	l (mm)
Kod No	ØD1 (mm)	ØD2 (mm)	s1 (mm)	s2 (mm)	e1 (mm)	e2 (mm)	l (mm)
18REAA110090 S	110	90	6,60	5,40	87,5	82,5	182,5
18REAA125090 S	125	90	7,40	5,40	90,5	82,5	193,0
18REAA125110 S	125	110	7,40	6,60	90,5	87,5	198,0
18REAA140090 S	140	90	8,30	5,40	96,0	82,5	198,5
18REAA140110 S	140	110	8,30	6,60	96,0	87,0	203,0
18REAA140125 S	140	125	8,30	7,40	96,0	90,5	206,5
18REAA160090 S	160	90	9,50	5,40	106,0	87,0	254,0
18REAA160110 S	160	110	9,50	6,60	106,0	87,0	213,0
18REAA160125 S	160	125	9,50	7,40	106,0	90,5	216,5
18REAA160140 S	160	140	9,50	8,30	106,0	96,0	222,0
18REAA180090 S	180	90	10,70	5,40	112,5	82,5	272,0
18REAA180110 S	180	110	10,70	6,60	112,5	87,0	276,5
18REAA180125 S	180	125	10,70	7,40	112,5	90,5	228,0
18REAA180140 S	180	140	10,70	8,30	112,5	96,0	233,5
18REAA180160 S	180	160	10,70	9,50	112,5	106,0	243,5
18REAA200090 S	200	90	11,90	5,40	117,0	82,5	281,5
18REAA200110 S	200	110	11,90	6,60	117,0	87,0	286,0
18REAA200125 S	200	125	11,90	7,40	117,0	90,5	289,5
18REAA200140 S	200	140	11,90	8,30	117,0	96,0	240,0
18REAA200160 S	200	160	11,90	9,50	117,0	106,0	250,0
18REAA200180 S	200	180	11,90	10,70	117,0	107,5	251,5
18REAA225090 S	225	90	13,40	5,40	110,0	82,5	320,5
18REAA225110 S	225	110	13,40	6,60	110,0	87,0	284,0
18REAA225125 S	225	125	13,40	7,40	110,0	90,5	287,5
18REAA225140 S	225	140	13,40	8,30	110,0	96,0	293,0
18REAA225160 S	225	160	13,40	9,50	110,0	106,0	243,0
18REAA225180 S	225	180	13,40	10,70	110,0	112,5	249,5
18REAA225200 S	225	200	13,40	11,90	110,0	117,0	254,0
18REAA250090 S	250	90	14,80	5,40	125,0	87,5	364,5
18REAA250110 S	250	110	14,80	6,60	125,0	87,0	364,0
18REAA250125 S	250	125	14,80	7,40	125,0	90,5	315,5
18REAA250140 S	250	140	14,80	8,30	125,0	96,0	321,0
18REAA250160 S	250	160	14,80	9,50	125,0	106,0	331,0
18REAA250180 S	250	180	14,80	10,70	125,0	112,5	267,5
18REAA250200 S	250	200	14,80	11,90	125,0	117,0	272,0
18REAA250225 S	250	225	14,80	13,40	125,0	110,0	265,0
18REAA280090 S	280	90	16,60	5,40	135,0	82,5	379,5
18REAA280110 S	280	110	16,60	6,60	135,0	87,0	384,0
18REAA280125 S	280	125	16,60	7,40	135,0	90,5	297,0
18REAA280140 S	280	140	16,60	8,30	135,0	96,0	338,0
18REAA280160 S	280	160	16,60	9,50	135,0	106,0	348,0
18REAA280180 S	280	180	16,60	10,70	135,0	112,5	354,5
18REAA280200 S	280	200	16,60	11,90	135,0	117,0	282,0
18REAA280225 S	280	225	16,60	13,40	135,0	110,0	275,0
18REAA280250 S	280	250	16,60	14,80	135,0	125,0	290,0
18REAA315110 S	315	110	18,70	6,80	144,0	87,0	403,0
18REAA315125 S	315	125	18,70	7,40	144,0	90,5	406,5
18REAA315140 S	315	140	18,70	8,30	144,0	96,0	412,0
18REAA315160 S	315	160	18,70	9,50	144,0	106,0	347,0
18REAA315180 S	315	180	18,70	10,70	144,0	112,5	353,5
18REAA315200 S	315	200	18,70	11,90	144,0	117,0	358,0
18REAA315225 S	315	225	18,70	13,40	144,0	110,0	284,0
18REAA315250 S	315	250	18,70	14,80	144,0	125,0	299,0
18REAA315280 S	315	280	18,70	16,60	144,0	135,0	309,0
18019355315S10	355	315	21,10	18,70			
18019400355S10	400	355	23,70	21,10			
18019450400S10	450	400	26,70	23,70			
18019500450S10	500	450	29,70	26,70			

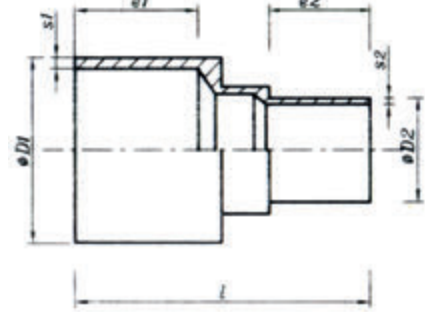
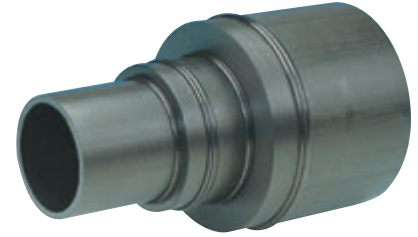

POLYETHYLENE (PE) SYSTEMS / POLİETİLEN BORU SİSTEMLERİ

SPIGOT END CAP  
SPİGOT KÖRTAPA  
ПЭ заглушка  
سدة

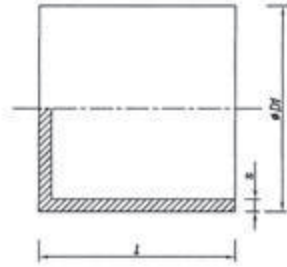

PE100 PN10

ITEM CODE	ØD1 (mm)	s(mm)	l(mm)
Kod No	ØD2 (mm)	s(mm)	l(mm)
18K0AA090 S	90	5,40	105
18K0AA110 S	110	6,60	122
18K0AA125 S	125	7,40	133
18K0AA140 S	140	8,30	148
18K0AA160 S	160	9,50	151
18K0AA180 S	180	10,70	190
18K0AA200 S	200	11,90	200
18K0AA225 S	225	13,40	210
18K0AA250 S	250	14,80	220
18K0AA280 S	280	16,60	230
18K0AA315 S	315	18,70	240
18014355 S	355		
18014400 S	400		
18014450 S	450		
18014500 S	500		

STEEL FLANGE  
ÇELİK FLANŞ  
Фланец (стальной)  
فلانج



ITEM CODE	DN
Kod No	DN
18FC090	90
18FC110	110
18FC125	125
18FC140	140
18FC160	160
18FC180	180
18FC200	200
18FC225	225
18FC250	250
18FC280	280
18FC315	315

PE MALE ADAPTOR  
PE ERKEK ADAPTÖR  
ПЭ адаптор с н.р.  
محول ذكربار



**PN 10**

**10 ATÜ YEŞİL SERİ**

ITEM CODE	DxR"(mm)
Kod No	DxR"(mm)
106500202020	20X1/2"
106500202525	25X3/4"
106500203240	32X1 1/4"
106500203225	32X3/4"
106500203232	32X1"
106500204040	40X1 1/4"
106500205050	50X1 1/2"
106500205063	50X2"
106500206363	63X2"
106500207575	75X2 1/2"
106500209090	90X3"
10650020110110	110X4"

PE MALE ADAPTOR  
PE ERKEK ADAPTÖR  
ПЭ адаптор с н.р.  
محول ذكربار



**PN 16**

**16 ATÜ MAVİ SERİ**

ITEM CODE	DxR"(mm)
Kod No	DxR"(mm)
106550202020	20X1/2"
106550202525	25X3/4"
106550203240	32X1 1/4"
106550203225	32X3/4"
106550203232	32X1"
106550204040	40X1 1/4"
106550205050	50X1 1/2"
106550205063	50X2"
106550206363	63X2"
106550207575	75X2 1/2"
106550209090	90X3"
10655020110110	110X4"

PE FEMALE ADAPTOR  
PE DİŞİ ADAPTÖR  
ПЭ адаптор с вн.р.  
محول انثى بار



**PN 10**

**10 ATÜ YEŞİL SERİ**

ITEM CODE	DxR"(mm)
Kod No	DxR"(mm)
106500212020	20X1/2"
106500212520	20X3/4"
106500212520	25X1/2"
106500212525	25X3/4"
106500213225	32X3/4"
106500213232	32X1"
106500214032	40X1"
106500214040	40X1 1/4"
106500205050	50X1 1/2"
106500215040	50X1 1/4"
106500206363	63X2"
106500207575	75X2 1/2"
106500209090	90X3"
10650020110110	110X4"

PE FEMALE ADAPTOR  
PE DİŞİ ADAPTÖR  
ПЭ адаптор с вн.р.  
محول انثى بار



**PN 16**

**16 ATÜ MAVİ SERİ**

ITEM CODE	DxR"(mm)
Kod No	DxR"(mm)
106550212020	20X1/2"
106550212520	20X3/4"
106550212520	25X1/2"
106550212525	25X3/4"
106550213225	32X3/4"
106550213232	32X1"
106550214032	40X1"
106550214040	40X1 1/4"
106550205050	50X1 1/2"
106550215040	50X1 1/4"
106550206363	63X2"
106550207575	75X2 1/2"
106550209090	90X3"
10655020110110	110X4"

PE REDUCER  
PE REDÜKSİYON  
ПЭ переходник  
نقاص بار



**PN 10P**

**10 ATÜ YEŞİL SERİ**

ITEM CODE	D1xD2(mm)
Kod No	D1xD2(mm)
106500042520	25x20
106500043220	32x20
106500043225	32x25
106500044032	40x32
106500045040	50x40
106500046350	63x50
106500047563	75x63
106500049075	90x75
1065000411090	110x90

PE REDUCER  
PE REDÜKSİYON  
ПЭ переходник  
نقاص بار



**N 16**

**16 ATÜ MAVİ SERİ**

ITEM CODE	D1xD2(mm)
Kod No	D1xD2(mm)
106550042520	25x20
106550043220	32x20
106550043225	32x25
106550044032	40x32
106550045040	50x40
106550046350	63x50
106550047563	75x63
106550049075	90x75
1065500411090	110x90



POLYETHYLENE (PE) SYSTEMS / POLİETİLEN BORU SİSTEMLERİ

**PUSH-IT FITTINGS / MEKANİK EK PARÇALARI**

PE MALE TEE  
PE ERKEK TE  
ПЭ тройник с н.р.  
تي ذكّر بار

PE MALE TEE  
PE ERKEK TE  
ПЭ тройник с н.р.  
تي ذكّر بار



PN 10

10 ATÜ YEŞİL SERİ	
ITEM CODE	DxR"(mm)
Kod No	DxR"(mm)
10650016202020	20x1/2"x20
10650016252525	20x3/4"x25
10650016252025	25x1/2"x25
10650016323232	32x1"x32
10650016322532	32x3/4"x32
10650016322032	32x1/2"x32
10650016404040	40x1 1/4"x40
10650016403240	40x1"x40
10650016505050	50x1 1/2"x50
10650016504050	50x1 1/4"x50
10650016503250	50x1"x50
10650016636363	63x2"x63"
10650016635063	63x1 1/2"x63
10650016757575	75x2 1/2"x75
10650016909090	90x3"x90

16 ATÜ MAVİ SERİ	
ITEM CODE	DxR"(mm)
Kod No	DxR"(mm)
10655016202020	20x1/2"x20
10655016252525	20x3/4"x25
10655016252025	25x1/2"x25
10655016323232	32x1"x32
10655016322532	32x3/4"x32
10655016322032	32x1/2"x32
10655016404040	40x1 1/4"x40
10655016403240	40x1"x40
10655016505050	50x1 1/2"x50
10655016504050	50x1 1/4"x50
10655016503250	50x1"x50
10655016636363	63x2"x63"
10655016635063	63x1 1/2"x63
10655016757575	75x2 1/2"x75
10655016909090	90x3"x90



PN 16

PE FEMALE TEE  
PE DİŞİ TE  
ПЭ тройник с вн.р.  
تي أنثى بار

PE FEMALE TEE  
PE DİŞİ TE  
ПЭ тройник с вн.р.  
تي أنثى بار



PN 10

10 ATÜ YEŞİL SERİ	
ITEM CODE	DxR"(mm)
Kod No	DxR"(mm)
10650017202020	20x1/2"x20
10650017252525	20x3/4"x25
10650017252025	25x1/2"x25
10650017323232	32x1"x32
10650017322532	32x3/4"x32
10650017322032	32x1/2"x32
10650017404040	40x1 1/4"x40
10650017403240	40x1"x40
10650017505050	50x1 1/2"x50
10650017504050	50x1 1/4"x50
10650017503250	50x1"x50
10650017636363	63x2"x63"
10650017635063	63x1 1/2"x63
10650017757575	75x2 1/2"x75
10650017909090	90x3"x90

16 ATÜ MAVİ SERİ	
ITEM CODE	DxR"(mm)
Kod No	DxR"(mm)
10655017202020	20x1/2"x20
10655017252525	20x3/4"x25
10655017252025	25x1/2"x25
10655017323232	32x1"x32
10655017322532	32x3/4"x32
10655017322032	32x1/2"x32
10655017404040	40x1 1/4"x40
10655017403240	40x1"x40
10655017505050	50x1 1/2"x50
10655017504050	50x1 1/4"x50
10655017503250	50x1"x50
10655017636363	63x2"x63"
10655017635063	63x1 1/2"x63
10655017757575	75x2 1/2"x75
10655017909090	90x3"x90



PN 16

PE TEE  
PE TE  
ПЭ тройник  
تي بار

PE TEE  
PE TE  
ПЭ тройник  
تي بار



PN 10

10 ATÜ YEŞİL SERİ	
ITEM CODE	DxDxD(mm)
Kod No	DxDxD(mm)
10650015202020	220x20x20
10650015252525	25x25x25
10650015323232	32x32x32
10650015404040	40x40x40
10650015505050	50x50x50
10650015636363	63x63x63
10650015757575	75x75x75
10650015909090	90x90x90
10650015110110	110x110x110

16 ATÜ MAVİ SERİ	
ITEM CODE	DxDxD(mm)
Kod No	DxDxD(mm)
10655015202020	220x20x20
10655015252525	25x25x25
10655015323232	32x32x32
10655015404040	40x40x40
10655015505050	50x50x50
10655015636363	63x63x63
10655015757575	75x75x75
10655015909090	90x90x90
10655015110110	110x110x110



PN 16

PE MALE ELBOW 90°  
PE ERKEK DİRSEK 90°  
ПЭ угольник 90° с  
كوع ذكر 90° بار



PN 10

**10 ATÜ YEŞİL SERİ**

ITEM CODE	DxR"(mm)
Kod No	DxR"(mm)

106500132020	20x1/2"
106500132520	25x1/2"
106500132525	25x3/4"
106500132232	32x1"
106500134040	40x1 1/4"
106500135050	50x1 1/2"
106500136363	63x2"

**16 ATÜ MAVİ SERİ**

ITEM CODE	DxR"(mm)
Kod No	DxR"(mm)

106550132020	20x1/2"
106550132520	25x1/2"
106550132525	25x3/4"
106550132232	32x1"
106550134040	40x1 1/4"
106550135050	50x1 1/2"
106550136363	63x2"

PE MALE ELBOW 90°  
PE ERKEK DİRSEK 90°  
ПЭ угольник 90° с н.р.  
كوع ذكر 90° بار



PN 16

PE FEMALE ELBOW 90°  
PE DİŞİ DİRSEK 90°  
ПЭ угольник 90° с в  
كوع أنثى 90° بار



PN 10

**10 ATÜ YEŞİL SERİ**

ITEM CODE	DxR"(mm)
Kod No	DxR"(mm)

106500122020	20x1/2"
106500122525	25x3/4"
106500122520	25x1/2"
106500123232	32x1"
106500124040	40x1 1/4"
106500125050	50x1 1/2"
106500126363	63x2"

**16 ATÜ MAVİ SERİ**

ITEM CODE	DxR"(mm)
Kod No	DxR"(mm)

106550122020	20x1/2"
106550122525	25x3/4"
106550122520	25x1/2"
106550123232	32x1"
106550124040	40x1 1/4"
106550125050	50x1 1/2"
106550126363	63x2"

PE FEMALE ELBOW 90°  
PE DİŞİ DİRSEK 90°  
ПЭ угольник 90° с вн.р.  
كوع أنثى 90° بار



PN 16

PE ELBOW 90°  
PE DİRSEK 90°  
ПЭ угольник 90°  
كوع 90° بار



PN 10

**10 ATÜ YEŞİL SERİ**

ITEM CODE	DxD(mm)
Kod No	DxD(mm)

106500102020	20x20
106500102525	25x25
106500103232	32x32
106500104040	40x40
106500105050	50x50
106500106363	63x63
106500107575	75x75
106500109090	90x90
10650010110110	110x110

**16 ATÜ MAVİ SERİ**

ITEM CODE	DxD(mm)
Kod No	DxD(mm)

106550102020	20x20
106550102525	25x25
106550103232	32x32
106550104040	40x40
106550105050	50x50
106550106363	63x63
106550107575	75x75
106550109090	90x90
10655010110110	110x110

PE ELBOW 90°  
PE DİRSEK 90°  
ПЭ угольник 90°  
كوع 90° بار



PN 16

PE END CAP  
PE KÖRTAPA  
ПЭ заглушка  
سدّة بار



PN 10

**10 ATÜ YEŞİL SERİ**

ITEM CODE	DxD(mm)
Kod No	DxD(mm)

106500140020	20
106500140025	25
106500140032	32
106500140040	40
106500140050	50
106500140063	63
106500140075	75
106500140090	90
106500140110	110

**16 ATÜ MAVİ SERİ**

ITEM CODE	DxD(mm)
Kod No	DxD(mm)

106550140020	20
106550140025	25
106550140032	32
106550140040	40
106550140050	50
106550140063	63
106550140075	75
106550140090	90
106550140110	110

PE END CAP  
PE KÖRTAPA  
ПЭ заглушка  
سدّة بار



PN 16

POLYETHYLENE (PE) SYSTEMS / POLİETİLEN BORU SİSTEMLERİ

**PUSH-IT FITTINGS / MEKANİK EK PARÇALARI**

PE COUPLING  
PE KAPLİNG

ПЭ муфта  
مجمع بار



**PN 10**

**10 ATÜ YEŞİL SERİ**

ITEM CODE	D(mm)
Kod No	D(mm)

106500010020	20
106500010025	25
106500010032	32
106500010040	40
106500010050	50
106500010063	63
106500010075	75
106500010090	90
1065000100110	110

PE COUPLING  
PE KAPLİNG

ПЭ муфта  
مجمع بار



**PN 16**

**16 ATÜ MAVİ SERİ**

ITEM CODE	D(mm)
Kod No	D(mm)

106550010020	20
106550010025	25
106550010032	32
106550010040	40
106550010050	50
106550010063	63
106550010075	75
106550010090	90
106550010110	110

PE COUPLER  
PE MANŞON

ПЭ терморезисторная муфта  
وصلة اليكتروفيزيون



ITEM CODE	Diameter D(mm)
Kod No	Çap(mm)

ODD020	20
ODD025	25
ODD032	32
ODD040	40
ODD050	50
ODD063	63
ODD075	75
ODD090	90
ODD110	110
ODD125	125
ODD140	140
ODD160	160
ODD180	180
ODD200	200*
ODD225	225*
ODD250	250*
ODD315	315*
ODD365	365*
ODD400	400*

PE BALL VALVE (Female-Male)  
KÜRESEL VANA (Dişi-Erkek)

ПЭ вентиль с н.р. и вн.р.  
صمام كروي (ذكر-أنثى)



ITEM CODE	DxR"(mm)
Kod No	DXR"(mm)

106361600002	32x1" Female/Dişi
106361600001	32x1" Male/Erkek

EF ELBOW 45°  
EF DİRSEK 45°

ПЭ терморезисторный угольник 45°  
كوع 45° اليكتروفيزيون



ITEM CODE	Diameter D(mm)
Kod No	Çap(mm)

OBT090	90
OBT110	110
OBT125	125
OBT160	160
OBT180	180

EF ELBOW 90°  
EF DİRSEK 90°

ПЭ терморезисторный угольник 90°  
كوع 90° اليكتروفيزيون



ITEM CODE	Diameter D(mm)
Kod No	Çap(mm)

OBS025	20
OBS032	25
OBS063	32
OBS090	40
OBS110	50
OBS125	63
OBS160	75
OBS180	90

EF EQUAL TEE  
EF EŞİT TE

ПЭ терморезисторный тройник  
تی متساویة الیکتروفیزیون



ITEM CODE Kod No	Diameter D(mm) Çap(mm)
OCS020	20
OCS025	25
OCS032	32
OCS040	40
OCS050	50
OCS063	63
OCS090	90
ODC110	110
OCS125	125
OCS160	160
OCS180	180

EF END CAP  
EF KÖRTAPA

ПЭ терморезисторная заглушка  
سدة الیکتروفیزیون



ITEM CODE Kod No	Diameter D(mm) Çap(mm)
OKA020	20
OKA025	25
OKA032	32
OKA040	40
OKA050	50
OKA063	63
OKA075	75
OKA090	90
OKA110	110
OKA125	125
OKA140	140
OKA160	160
OKA180	180

EF REDUCER  
EF REDÜKSİYON

ПЭ терморезисторный переходник  
نقاص الیکتروفیزیون



ITEM CODE Kod No	Diameter D1xD2(mm) Çap(mm)
DCOC0250020	25x20
DCOC0320020	32x20
DCOC0320025	32x25
DCOC0400032	40x32
DCOC0630032	63x32
DCOC0630040	63x40
DCOC0630050	63x50
DCOC0900063	90x63
DCOC1100063	110x63
DCOC1100090	110x90
DCOC1250063	125x63
DCOC1250090	125x90
DCOC1600110	160x110
DCOC1800125	180x125
DCOC2000160	200x160
DCOC2250160	225x160
DCOC2500180	250x180
DCOC3150250	315x250

EF TAPPING TEE  
EF SERVİS TE

ПЭ терморезисторное седло  
تی الیکتروفیزیون



ITEM CODE Kod No	Diameter D1xD2(mm) Çap(mm)
OCS0400032	40x32
OCS0500032	50x32
OCS0620032	62x32
OCS0750032	75x32
OCS0900032	90x32
OCS1100032	110x32
OCS1250032	125x32
OCS1400032	140x32
OCS1600032	160x32
OCS1800032	180x32
OCS2000032	200x32
OCS2250032	225x32
OCS2500032	250x32
OCS2800032	280x32
OCS3150032	315x32
OCS3550032	355x32
OCS4000032	400x32
OCS0630063	63x63
OCS0900063	90x63
OCS1100063	110x63
OCS1250063	125x63
OCS1400063	140x63
OCS1600063	160x63
OCS1800063	180x63
OCS2000063	200x63
OCS2250063	225x63
OCS2500063	250x63
OCS2800063	280x63
OCS3150063	315x63
OCS3550063	355x63
OCS4000063	400x63
OCS4500063	450x63
OCS5000063	500x63



**NATURAL  
GAS SYSTEMS**

**DOĞALGAZ  
SİSTEMLERİ**



TS EN ISO 9001:2000



TS EN 1555-2



## NATURAL GAS PIPES

Egeplast manufactures natural gas pipes using medium density polyethylene resin. These pipes are yellow. Among the general characteristics of polyethylene, flexibility allows the pipes to have superior impact resistance, therefore polyethylene pipes are widely used for inner-city gas distribution lines.

### NATURAL GAS FITTINGS

Polyethylene natural gas pipelines are being installed by electrofusion and butt fusion techniques. Fittings for these systems are imported from Europe.

### NATURAL GAS PIPES

**RAW MATERIAL: PE80, MEDIUM DENSITY POLYETHYLENE**

**COLOR: YELLOW**

**STANDARD: TS EN 1555-2**

Natural gas pipes are manufactured in coils up to Ø125 mm and in 6 or 12 mt net lengths above 125 mm size. Standard coil length is 100 mt.

### ELECTROFUSION FITTINGS

Electrofusion (EF) fittings supplied by Egeplast can be properly used with both natural gas and potable water pipeline systems. PE80 and PE100 EF fittings are available. EF fittings are designed for 40V constant voltage. Each fittings has a barcode on it.

## DOĞALGAZ BORULARI

Egeplast A.Ş. doğalgaz borularını, Avrupa'nın önde gelen hammadde üreticilerinden temin ettiği orta yoğunluklu polietilen PE80'den imal etmektedir. Özellikle basınçlı boru uygulamaları için en uygun malzeme olan polietilenden imal edilen doğalgaz borularımız sarı renklidir. Polietilenin temel özelliklerinden olan esnek bir malzeme olması çok düşük sıcaklıklarda bile darbe dayanımını garantilemekte ve dolayısı ile doğalgaz gibi çok önemli bir servisin şehir içi dağıtım hatlarında yaygın bir şekilde kullanımını sağlamaktadır.

### DOĞALGAZ EK PARÇALARI

Polietilen doğalgaz hatlarının montajında elektrofüzyon kaynağı ve alın kaynağı ile birleşim sağlanmaktadır. Egeplast A.Ş. tarafından imal edilen doğalgaz boruları ile birlikte kullanılan ek parçalar Avrupa'dan ithal edilmektedir.

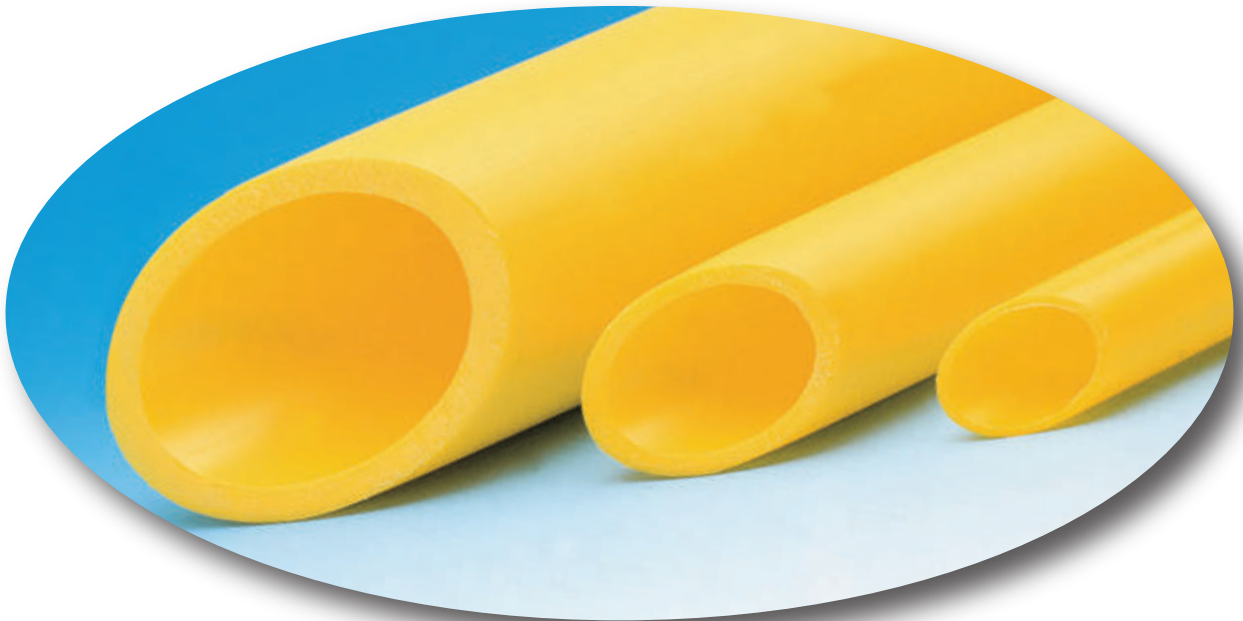

NATURAL GAS SYSTEMS / DOĞALGAZ SİSTEMLERİ

NATURAL GAS PIPES  
DOĞALGAZ BORULARI  
ПЭ80 труба для природного газа  
أنابيب الغاز الطبيعي



Coil Dimentions / Kanganl Boyutlar

Outside Diameter	Standart Coil Lenght	Min.Inside Diameter(mm)	Outside Diameter (mm)	Width(mm)	Coil Weight (kg)
Boru Çapı	Standart Kanganl Boyu(m)	Min. İç. Çap	Dış Çap(mm)	En (mm)	Kanganl Ağırlığı (kg)
20	100	0,60	0,90	0,15	16,2
25	100	0,60	0,90	0,20	21,1
32	100	0,80	1,20	0,20	27,9
40	100	0,80	1,20	0,30	43
50	100	1,00	1,50	0,30	66,6
63	100	1,25	1,75	0,45	105
75	100	1,50	2,10	0,45	148
90	100	1,80	2,50	0,42	212
110	100	2,30	2,95	0,55	314
125	100	2,30	3,05	0,65	408

- \*125 mm & bigger diametres are manufactured in 6 or 12 meter lenghts.
- \* O.D. 125 mm is manufactured both in coil and 6 or 12 m. straight lenghts.
- \*125 mm ve üzeri çaplar 6 veya 12 mt düz boylarda imal edilir.
- \* 125 mm hem düz hem kanganl olarak imal edilmektedir.

EF COUPLER  
EF MANŞON  
ПЭ муфта терморезисторная  
صربط اليكتروفیزیون



ITEM CODE	PE80 SDR11 Diameter
Kod No	Çap(mm)
00D020	20
00D025	25
00D032	32
00D040	40
00D050	50
00D063	63
00D075	75
00D090	90
00D110	110
00D125	125
00D140	140
00D160	160
00D180	180
00D200	200
00D225	225
00D250	250
00D315	315
00D355	355

ITEM CODE	D1 (mm)	SDR	Wall Thickness	Weight (kg/m)
Kod No	D1 (mm)	SDR	Standart Et Kalınlığı	Ağırlık (kg/m)
110010200011	Ø20	SDR11	3,00	0,162
110010250011	Ø25	SDR11	3,00	0,211
110010320011	Ø32	SDR11	3,00	0,279
110010400011	Ø40	SDR11	3,70	0,430
110010500011	Ø50	SDR11	4,60	0,666
110010630011	Ø63	SDR11	5,80	1,050
110010750011	Ø75	SDR11	6,80	1,480
110010900011	Ø90	SDR11	8,20	2,120
110011100011	Ø110	SDR11	10,00	3,140
110011250011	Ø125	SDR11	11,40	4,080
110011400011	Ø140	SDR11	12,70	5,110
110011600011	Ø160	SDR11	14,60	6,670
110011800011	Ø180	SDR11	16,40	8,420
110012000011	Ø200	SDR11	18,20	10,400
110012250011	Ø225	SDR11	20,50	13,100
110012500011	Ø250	SDR11	22,70	16,200
110012800011	Ø280	SDR11	25,40	20,300
110013150011	Ø315	SDR11	28,60	25,700
110013550011	Ø355	SDR11	32,30	32,600
110014000011	Ø400	SDR11	36,40	41,400
110014500011	Ø450	SDR11	40,90	52,400
110015000011	Ø500	SDR11	45,50	64,850
110015600011	Ø560	SDR11	50,90	81,462
110016300011	Ø630	SDR11	57,30	102,800

NATURAL GAS SYSTEMS / DOĞALGAZ SİSTEMLERİ

ITEM CODE PE80 SDR11  
Diameter

Kod No Çap(mm)

OBS025	25
OBS032	32
OBS063	63
OBS090	90
OBS110	110
OBS125	125
OBS160	160
OBS180	180

EF ELBOW 90°  
EF DİRSEK 90°  
ПЭ угольник 90 терморезисторный  
كوع 90° اليكتروفزيون



ITEM CODE PE80 SDR11  
Diameter

Kod No Çap(mm)

OBT090	90
OBT110	110
OBT125	125
OBT160	160
OBT180	180

EF ELBOW 45°  
EF DİRSEK 45°  
ПЭ угольник 45 терморезисторный  
كوع 45° اليكتروفزيون



ITEM CODE PE80 SDR11  
Diameter

Kod No Çap(mm)

OCS020	20
OCS025	25
OCS032	32
OCS040	40
OCS050	50
OCS063	63
OCS090	90
OCS110	110
OCS125	125
OCS160	160
OCS180	180

EF EQUAL TEE  
EF EŞİT TE  
ПЭ тройник терморезисторный  
تي متساوية اليكتروفزيون



NATURAL GAS SYSTEMS / DOĞALGAZ SİSTEMLERİ

EF TAPPING TEE

EF SERVİS TE

ПЭ седло отвод терморезисторное

مخرج اليكتروفيزيون



ITEM CODE	PE80 SDR11 Diameter
Kod No	Çap(mm)
OCS0400032	40x32
OCS0500032	50x32
OCS0630032	63x32
OCS0750032	75x32
OCS0900032	90x32
OCS1100032	110x32
OCS1250032	125x32
OCS1400032	140x32
OCS1600032	160x32
OCS1800032	180x32
OCS2000032	200x32
OCS2250032	225x32
OCS2500032	250x32
OCS2800032	280x32
OCS3150032	315x32
OCS3550032	355x32

ITEM CODE	PE80 SDR11 Diameter
Kod No	Çap(mm)
OCS4000032	400x32
OCS0630063	63x63
OCS0900063	90x63
OCS1100063	110x63
OCS1400063	140x63
OCS1600063	160x63
OCS1800063	180x63
OCS2000063	200x63
OCS2250063	225x63
OCS2500063	250x63
OCS2800063	280x63
OCS3150063	315x63
OCS3550063	355x63
OCS4000063	400x63
OCS4500063	450x63
OCS5000063	500x63

EF REDUCER

EF REDÜKSİYON

ПЭ переходник терморезисторный

نقاص اليكتروفيزيون



ITEM CODE	PE80 SDR11 Diameter
Kod No	Çap(mm)
DC0C0250020	25x20
DC0C0320020	32x20
DC0C0320025	32x25
DC0C0400032	40x32
DC0C0630032	63x32
DC0C0630040	63x40
DC0C0630050	63x50
DC0C0900063	90x63
DC0C1100063	110x63
DC0C1100090	110x90
DC0C1250063	125x63
DC0C1250090	125x90
DC0C1600110	160x110
DC0C1800125	180x125
DC0C2000160	200x160
DC0C2250160	225x160
DC0C2500180	250x180
DC0C3150250	315x250

EF END CAP

EF KÖR TAPA

ПЭ заглушка терморезисторная

سدة اليكتروفيزيون



ITEM CODE	PE80 SDR11 Diameter
Kod No	Çap(mm)
OKA020	20
OKA025	25
OKA032	32
OKA040	40
OKA050	50
OKA063	63
OKA075	75
OKA090	90
OKA110	110
OKA125	125
OKA140	140
OKA160	160
OKA180	180

# DRAINAGE SYSTEMS

## DRENAJ SİSTEMLERİ



TS EN ISO 9001:2000



TS 9128



## DRAINAGE PIPES

Drainage pipes are spiral pipes made from UPVC to drain harmful water (under or above ground). Pipes are manufactured both flat and perforated. Perforated pipes collect water and drain, flat pipes transfer the water collected by perforated pipes to drainage waterways, creeks or rivers. These pipes are manufactured in accordance with TS 9128 and DIN 1187 in yellow color and between 80 – 200 mm size.

## DRAINAGE FITTINGS

Fittings are manufactured between 80 – 200 mm sizes. These fittings are: end plug, sleeve, single and double branch, elbows 45° and 87,5° reducer and tee branch.

## DRENAJ BORULARI

Drenaj boruları, yeraltı ve yerüstünde oluşan zararlı suların bölgeden uzaklaştırılmasında kullanılan PVC-U (Yumuşatıcısız Polivinil Klorür) malzemeden imal edilen daire kesitli borulardır. Delikli ve deliksiz olarak üretimi yapılmaktadır. Delikli drenaj boruları (Toplayıcı Borular), üzerindeki delikler vasıtasıyla suları toplayıp bölgeden uzaklaştırmakta, Deliksiz Drenaj Boruları (Tahliye Borular), Toplayıcı Borular yardımıyla toplanan suları drenaj kanalı, dere veya nehir gibi yerlere taşımakta kullanılırlar.

Drenaj borularının kullanımı ile ilgili detaylı bilgi firmamızın DRENAJ VE TOPRAK ISLAHI adlı kitapçığında mevcuttur.

Bu boruların üretimi Türk Standardı TS 9128 ve Alman Standardı DIN 1187'ye uygun olarak sarı renkte 80 – 200 mm dış çap aralığında yapılmaktadır.

Ek parçalar 80 – 200 mm çap aralığında yapılmaktadır. Bu ek parçalar körtapa, manşon, tek çatal, açık dirsek, redüksiyon, çift çatal ve TE çataldan oluşmaktadır.

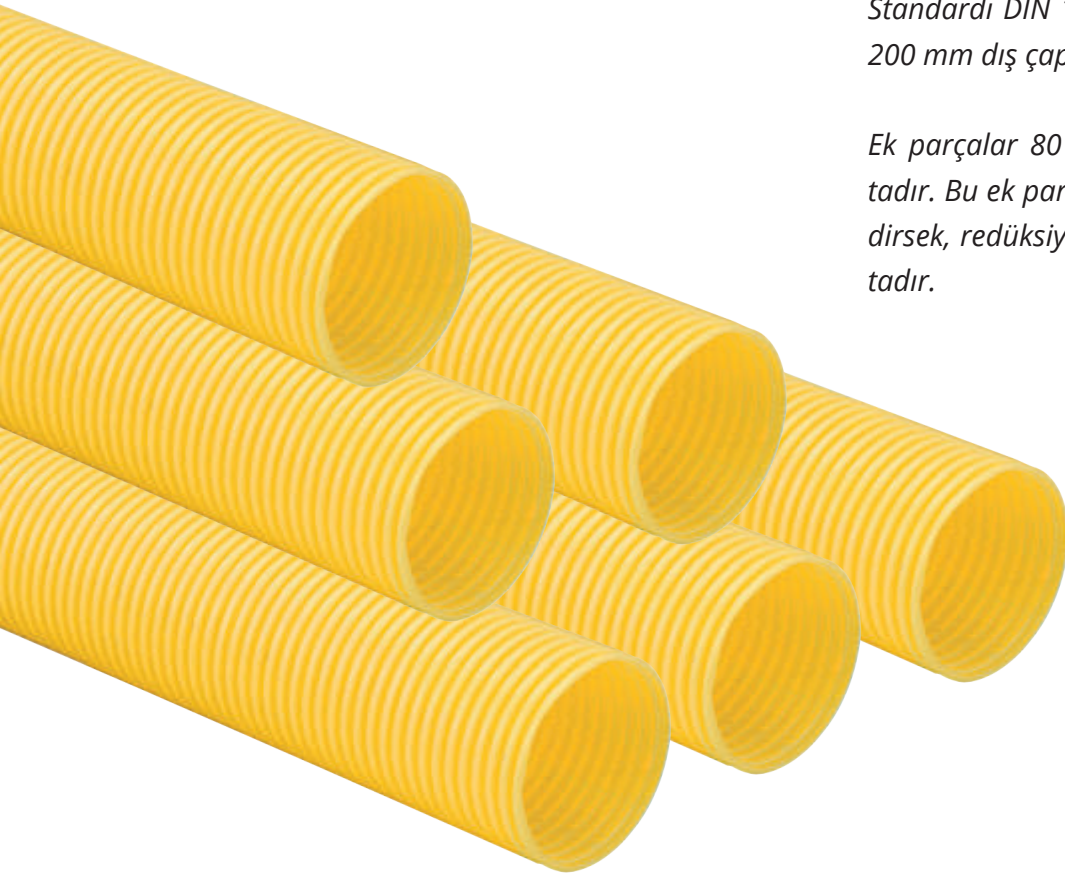



DRAINAGE SYSTEMS / DRENAJ SİSTEMLERİ

PIPE  
DRENAJ BORUSU  
ПВХ труба для дренажных систем  
أنابيب زهنية

ITEM CODE	ØD(mm)	Ød(mm)	COIL LENGHT	COIL DIMENSIONS LxDxO.Dxnxwidth	UNIT WEIGHT (kg/m)
Kod No	ØD(mm)	Ød(mm)	Kangal Boyu (m)	Kangal Ebadı(m) iççap x dışçap x en	Birim Ağırlık (kg/m)
21001080	80	71,5	100	0,6 x 1,4 x 0,6	0,320
21001100	100	90	100	0,7 x 1,6 x 0,6	0,390
21001125	125	115,5	100	0,75 x 1,9 x 0,6	0,540
21001160	160	145,5	50	1,0 x 1,9 x 0,65	0,850
21001200	200	184,5	50	1,0 x 2,2 x 0,8	1,250

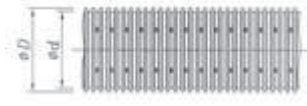

SLEEVE  
DRENAJ MANŞONU  
ПВХ муфта для дренажных систем  
مربط وصل

ITEM CODE	Ød(mm)	l(mm)
Kod No	Ød(mm)	l(mm)
21015080	80	110
21015100	100	110
21012125	125	125
21015160	160	160
21015200	200	160

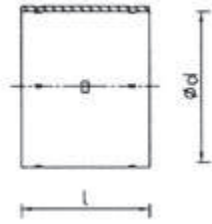

ELBOW 45°  
DRENAJ AÇIK DİRSEK 45°  
ПВХ угольник 45° для дренажных систем  
كوع 45°

ITEM CODE	Ød(mm)	l(mm)
Kod No	Ød(mm)	l(mm)
21037080	80	40
21037100	100	50
21037125	125	90
21037160	160	130
21037200	200	140

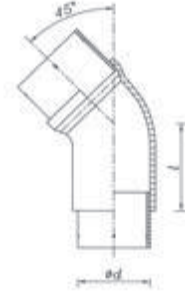

ELBOW 87,5°  
DRENAJ KAPALI DİRSEK 87,5°  
ПВХ угольник 87,5° для дренажных систем  
كوع 87,5°

ITEM CODE	Ød(mm)	l(mm)
Kod No	Ød(mm)	l(mm)
21038080	80	80
21038100	100	80
21038125	125	120
21038160	160	180
21038200	200	200

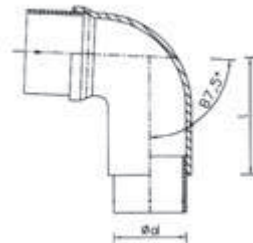

DRAINAGE SYSTEMS / DRENAJ SİSTEMLERİ

SINGLE BRANCH 45°  
DRENAJ TEK ÇATAL 45°  
ПВХ тройник 45° для дренажных систем  
وصله زنجبیل 45°

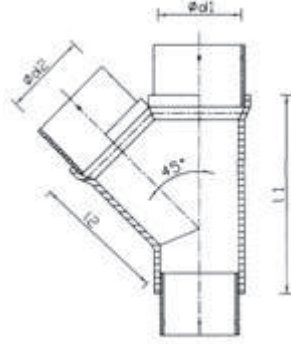

ITEM CODE	Ød1/Ød2 (mm)	l1 (mm)	l2 (mm)
Kod No	Ød1Ød2 (mm)	l1 (mm)	l2 (mm)
210300800080	80/80	210	150
21030100	100/100	180	140
210301250100	125/100	300	150
210301250125	125/125	320	250
210301600100	160/100	370	170
210301600125	160/125	390	330
210301600160	160/160	440	340
210302000100	200/100	440	230
210302000125	200/125	440	360
210302000160	200/160	440	340
210302000200	200/200	550	450

TEE BRANCH 87,5°  
DRENAJ TE ÇATAL 87,5°  
ПВХ тройник 87,5° для дренажных систем  
تنبي 87,5°

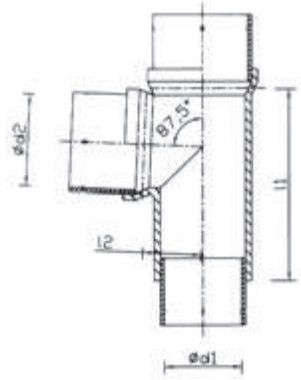

ITEM CODE	Ød1/Ød2 (mm)	l1 (mm)	l2 (mm)
Kod No	Ød1Ød2 (mm)	l1 (mm)	l2 (mm)
210290800080	80/80	180	60
210290100080	100/80	120	80
210291000100	100/100	130	60
210291250080	125/80	270	160
210291250100	125/100	270	90
210291250125	125/125	270	150
210291600080	160/80	360	280
210291600100	160/100	360	250
210291600125	160/125	360	250
210291600160	160/160	360	210
210292000080	200/80	430	230
210292000100	200/100	430	140
210292000125	200/125	430	270
210292000160	200/160	430	240
210292000200	200/200	470	250

DOUBLE BRANCH 45°  
DRENAJ ÇİFT ÇATAL 45°

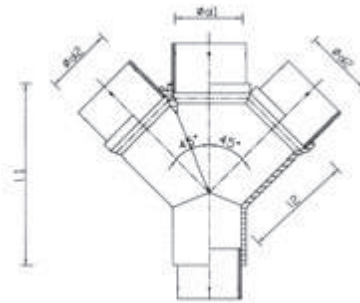

ITEM CODE	Ød1/Ød2 (mm)	l1 (mm)	l2 (mm)
Kod No	Ød1Ød2 (mm)	l1 (mm)	l2 (mm)
210280800080	80/80	180	60
210281000100	100/100	210	120
210281250100	125/100	310	140
210281250125	125/125	410	280
210281600100	160/100		
210291600125	160/125		
210291600160	160/160		

DRAINAGE SYSTEMS / DRENAJ SİSTEMLERİ

REDUCER  
DRENAJ REDÜKSİYON

ПВХ переходник для дренажных систем  
نقاص

ITEM CODE	Ød1/Ød2 (mm)	l(mm)
Kod No	Çap (mm)	l(mm)
210191000080	100/80	70
210191250100	125/100	50
210191600125	160/125	150
210191600100	160/100	80
210192000100	200/100	200
210192000125	200/125	290
210192000160	200/160	230

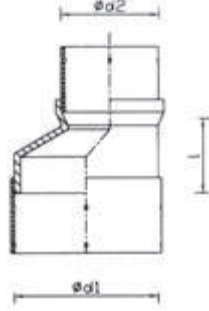

ENDPLUG  
DRENAJ KÖRTAPA

ПВХ заглушка для дренажных систем  
سدّة

ITEM CODE	Ød (mm)	l(mm)
Kod No	Çap (mm)	l(mm)
21014080	80	110
21014100	100	80
21014125	125	110
21014160	160	140
21014200	200	140

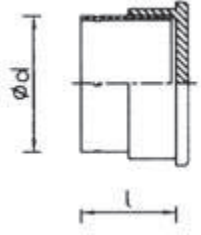

DRAINAGE CROSS  
DRENAJ İSTAVROZ

ПВХ Крестовина для дренажных систем  
مشتك للتصريف

ITEM CODE	Ød (mm)	l(mm)
Kod No	Çap (mm)	l(mm)
216310800080	80/80	
216311000080	100/80	
216311000100	100/100	
216311600080	160/80	
216311600100	160/100	
216311600125	160/125	
216311600160	160/160	



**PE  
TELECOMMUNICATION  
SYSTEMS**

**PE  
TELEKOMÜNİKASYON  
SİSTEMLERİ**



TS EN ISO 9001:2000



HDPE CORRUGATED PIPES  
HDPE KORUGE BORUSU  
ПЭ гофрированная труба  
أنابيب البولي اثيلين



ITEM CODE	Ød (mm)	ØD (mm)	Lenght(m)
Kod No	Ød (mm)	ØD (mm)	Boy(m)
240011106000CO	100	116	6
240011101200CO	100	116	12

SLEEVE  
BİRLEŞTİRME MANŞONU  
ПЭ соединительная муфта для гофра-труб  
وصلة

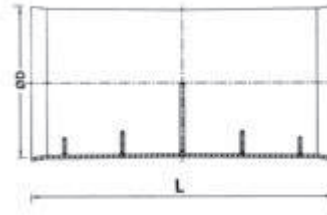

ITEM CODE	ØD (mm)	l(m)
Kod No	ØD (mm)	l(m)
24015110	120	250

ADAPTOR  
ADAPTÖR  
ПЭ адаптор для гофра-труб  
وصلة مزدوجة

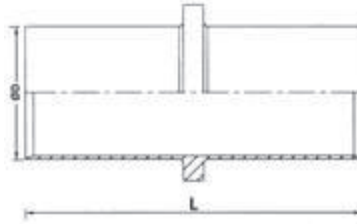
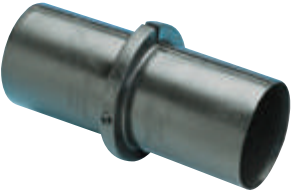

ITEM CODE	ØD (mm)	l(m)
Kod No	ØD (mm)	l(m)
24003110 Y	98	250

REPAIRING SLEEVE  
TAMİR MANŞONU  
ПЭ ремонтная подвижная муфта для гофра-труб  
وصلة إصلاح

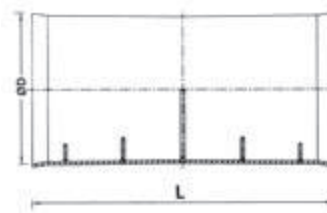

ITEM CODE	ØD (mm)	l(m)
Kod No	ØD (mm)	l(m)
24017110 Y	120	250



ITEM CODE	ØD (mm)	Lenght(m)
Kod No	ØD (mm)	Boy(m)
240151106000	100	6



PVC REPAIRING SLEEVE (2 PARTS)  
PVC PARÇALI TAMİR MANŞONU

ПЭ удлинительная ремонтная муфта для гофра-труб  
وصلة إصلاح

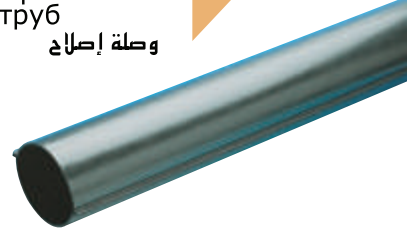

ITEM CODE	Ød (mm)	ØD (mm)	Lenght(m)
Kod No	Ød (mm)	ØD (mm)	Boy(m)
24014110	100	116	6

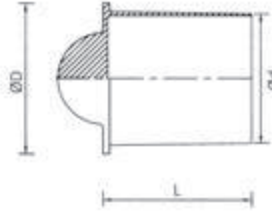

END PLUG  
KÖRTAPA

ПЭ заглушка для гофра-труб  
سدّة



ITEM CODE	Ød (mm)	l(mm)	h
Kod No	Ød (mm)	l(mm)	h
240060020110 Y	120	150	190

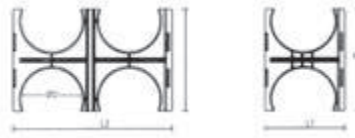

PVC PIPE SUPPORT (2 Grooves)  
pvc boru desteği (2'li)

ПЭ заглушка для гофра-труб  
سدّة



ITEM CODE	Ød (mm)	l(mm)	h
Kod No	Ød (mm)	l(mm)	h
240060020110 Y	116	290	190

PVC PIPE SUPPORT (4Grooves)  
pvc boru desteği (4'lü)

Опора четверная для гофра-труб  
مثبت أنابيب



ITEM CODE	ØD (mm)
Kod No	ÇAP (mm)
24031110 Y	100

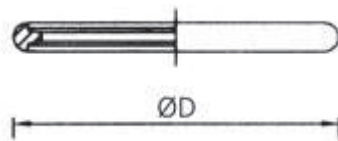

Резиновое кольцо для гофра-труб  
جوان

O-RING  
CONTA



PE CABLE DUCTS / PE TELEKOMÜNİKASYON SİSTEMLERİ

Ø40 mm SINGLE DUCT  
Ø40 mm TEKLİ GÖZ ÇOKLAYICI  
40мм ПЭ одинарная труба  
أنبوب 40 مم

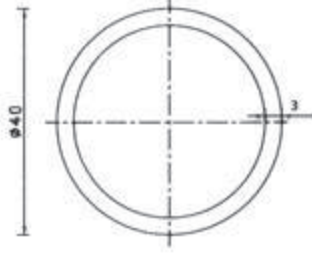
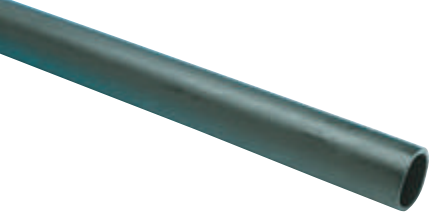

ITEM CODE WALL THICKNESS UNIT WEIGHT RESIN COLOR

Kod No Et Kalınlığı Birim Ağırlık Malzeme Renk

18000040 37 3,7 mm 0,430kg/mt HDPE Siyah(Black)  
Mavi (Blue)

Ø40 mm SINGLE DUCT  
Ø40 mm TEKLİ GÖZ ÇOKLAYICI  
40мм ПЭ одинарная труба  
أنبوب 40 مم

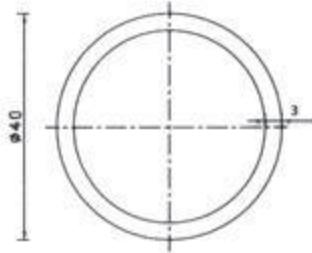
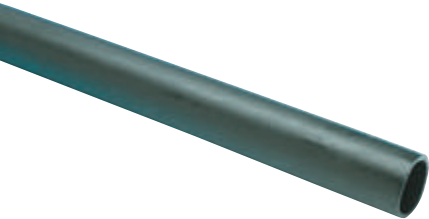

ITEM CODE WALL THICKNESS UNIT WEIGHT RESIN COLOR

Kod No Et Kalınlığı Birim Ağırlık Malzeme Renk

18001040 03 3,0 mm 0,357kg/mt HDPE Siyah(Black)

Ø40 x Ø40 mm DOUBLE DUCT  
Ø40 X Ø40 mm İKİLİ GÖZ ÇOKLAYICI  
40x40mm ПЭ двойная труба  
أنبوب مزدوج 40 مم

ITEM CODE	WALL THICKNESS	UNIT WEIGHT	RESIN	COLOR
Kod No	Et Kalınlığı	Birim Ağırlık	Malzeme	Renk
1800004000 4037	3,7x3,7 mm	0,890kg/mt	HDPE	Siyah(Black) Mavi (Blue)

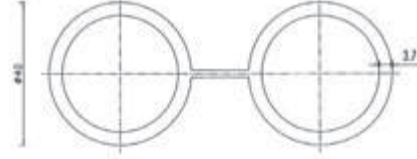

Ø40 x Ø40 mm DOUBLE DUCT  
Ø40 x Ø40 mm İKİLİ GÖZ ÇOKLAYICI



Ø32 x Ø32 mm DOUBLE DUCT  
Ø32 x Ø32 mm İKİLİ GÖZ ÇOKLAYICI  
32x32mm ПЭ двойная труба  
أنبوب مزدوج 32 مم

ITEM CODE	WALL THICKNESS	UNIT WEIGHT	RESIN	COLOR
Kod No	Et Kalınlığı	Birim Ağırlık	Malzeme	Renk
1800003200 3220	2,0x2,0 mm	0,422kg/mt	HDPE	Siyah(Black) Mavi (Blue)

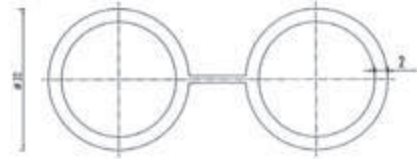

Ø32 x Ø32 mm DOUBLE DUCT  
Ø32 x Ø32 mm İKİLİ GÖZ ÇOKLAYICI



Ø32 x Ø40 x Ø32 mm TRIPLE DUCT  
Ø32 x Ø40 X Ø32 mm ÜÇLÜ GÖZ ÇOKLAYICI  
32x40x32mm ПЭ тройная труба  
32x40x32mm أنبوب ثلاثي

ITEM CODE	WALL THICKNESS	UNIT WEIGHT	COAT THICKNESS	RESIN	COLOR
Kod No	Et Kalınlığı	Birim Ağırlık	Kaplama Kalınlığı	Malzeme	Renk
181000323240	2,0x2,0x2,0 mm	0,780kg/mt	0,5 mm	LDPE-HDPE	Siyah(Black)

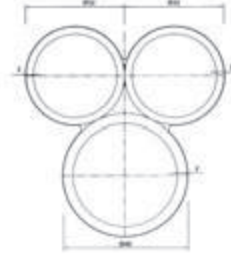

Ø32 x Ø40 x Ø32 mm TRIPLE DUCT  
Ø32 x Ø40 x Ø32 mm ÜÇLÜ GÖZ ÇOKLAYICI



Ø40 x Ø50 x Ø40 mm TRIPLE DUCT  
Ø40 x Ø50 X Ø50 mm ÜÇLÜ GÖZ ÇOKLAYICI  
40x50x40mm ПЭ тройная труба  
40x50x40mm أنبوب ثلاثي

ITEM CODE	WALL THICKNESS	UNIT WEIGHT	COAT THICKNESS	RESIN	COLOR
Kod No	Et Kalınlığı	Birim Ağırlık	Kaplama Kalınlığı	Malzeme	Renk
180030404050	2,0x2,0x2,0 mm	1,388kg/mt	0,5 mm	LDPE-HDPE	Siyah(Black)

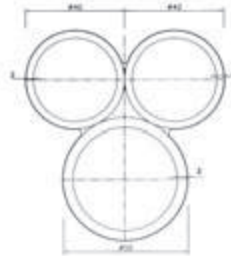

Ø40 x Ø50 x Ø40 mm TRIPLE DUCT  
Ø40 x Ø50 x Ø40 mm ÜÇLÜ GÖZ ÇOKLAYICI



\*Ø32, Ø40 and Ø50 mm. couplings and end plugs are available for cable ducts.

\*Göz çoklayıcılar için Ø32, Ø40 ve Ø50 mm çaplarında birleştirme manşonu ve tıkama kepi mevcuttur.

# Kalite Belgelerimiz



PPRC HİJYEN

PE HİJYEN RUSYA BELARUS KAZAKİSTAN

PVC TEMİZ SU HİJYEN

TS EN 12201-2+A1 / PE100 BORU

TS EN 13476-3+A1 / KORUGE BORU

TS EN ISO 1452-2 / PVC-U TEMİZ SU BORULAR

TS 10762-2 EN ISO 15875-2 / PEX B BORULAR

TS EN 1401-1 / PVC-U KANALİZASYON BORULARI

TS 9128 / PVC-U DRENAJ BORULARI

TS 13715 / EGEKOMPOZİT BORULAR

TS EN 607 / PVC-U YAĞMUR OLUĞU VE EK PARÇALARI

TS EN ISO 15874-3 / EGETHERM EK PARÇALARI

TS EN 1329-1 / PVC-U PİSSU BORU VE EKLEME PARÇALAR

TS EN ISO 15874-2 / EGETHERM BORULARI

TS EN 1452-3 / PVC-U TEMİZ SU EK PARÇA

TS EN ISO 9261 / DAMLAMA BORULARI

TS EN 12201-3 +A1 / PE 100 EK PARÇALAR(ALIN KAYNAKLI)

TS EN 1555-2 / PE 80 DOĞALGAZ BORULARI



PPRC TEMİZ SU HİJYENTS EN ISO 1451-1 / PP PİS BORU VE EKLEME PARÇALARI



**ECEPLAST**  
"quality at plastic pipe"

#### İZMİR FACTORY & HEAD OFFICE

10003 Sok. No:6 Atatürk Organize Sanayi Bölgesi Çiğli - İZMİR  
T. +90 (232) 376 66 31  
F. +90 (232) 376 81 43

#### İSTANBUL KOZYATAĞI BRANCH OFFICE

Kozyatağı Bayar Cad. Gülbahar Sok. No:15  
Ege Yıldız Sitesi Kadıköy - İSTANBUL  
T. +90 (216) 362 97 27  
F. +90 (216) 373 88 32

#### İSTANBUL RAMİ BRANCH OFFICE

Kışla Cad. Sanayi Sok. No:16 Bayrampaşa - İSTANBUL  
T. +90 (212) 563 95 80 - 89  
F. +90 (212) 563 95 85

#### ANKARA BRANCH OFFICE

Rüzgarlı Ege Sok. Ege Yıldız İşhanı Ulus - ANKARA  
T. +90 (312) 310 31 85  
F. +90 (312) 310 01 84

#### ANTALYA BRANCH OFFICE

Meydan Kavşağı Mahallesi Perge Bulvarı Taha Berk Apt. K:1 D:4 - ANTALYA  
T. +90 (242) 321 39 90  
F. +90 (242) 321 39 92

#### ADANA BRANCH OFFICE

Ceyhan yolu üzeri 2. km EBK Karşısı Yüreğir - ADANA  
T. +90 (322) 346 74 21  
F. +90 (322) 346 74 20

[www.egeplast.com.tr](http://www.egeplast.com.tr)  
[export@egeplast.com.tr](mailto:export@egeplast.com.tr)

[www.egeyildiz.com.tr](http://www.egeyildiz.com.tr)  
[satis@egeyildiz.com.tr](mailto:satis@egeyildiz.com.tr)



**EGE YILDIZ**  
"plastik boruda kalite"